

MAGNUMSTONE™

TECHNICAL REFERENCE MANUAL

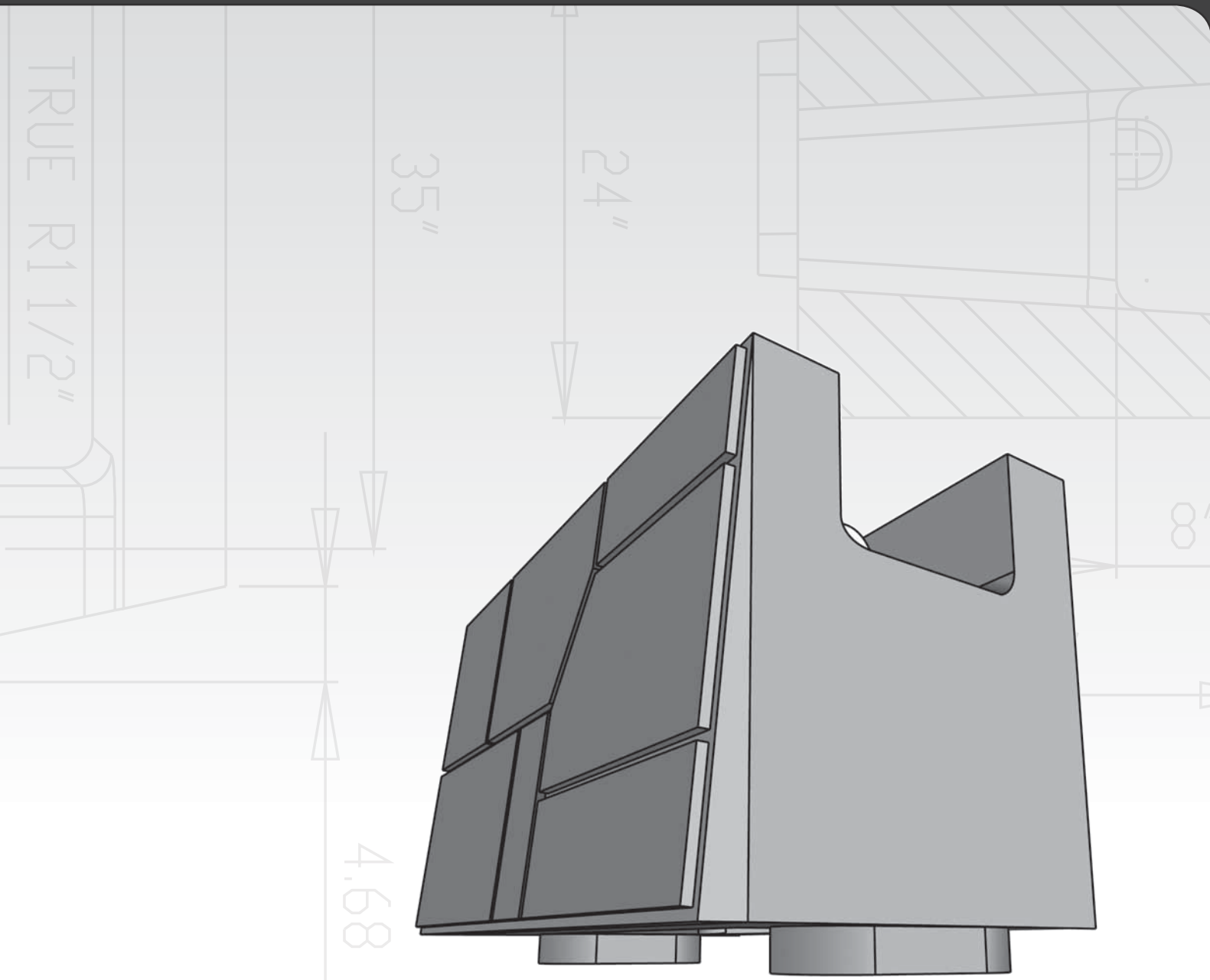

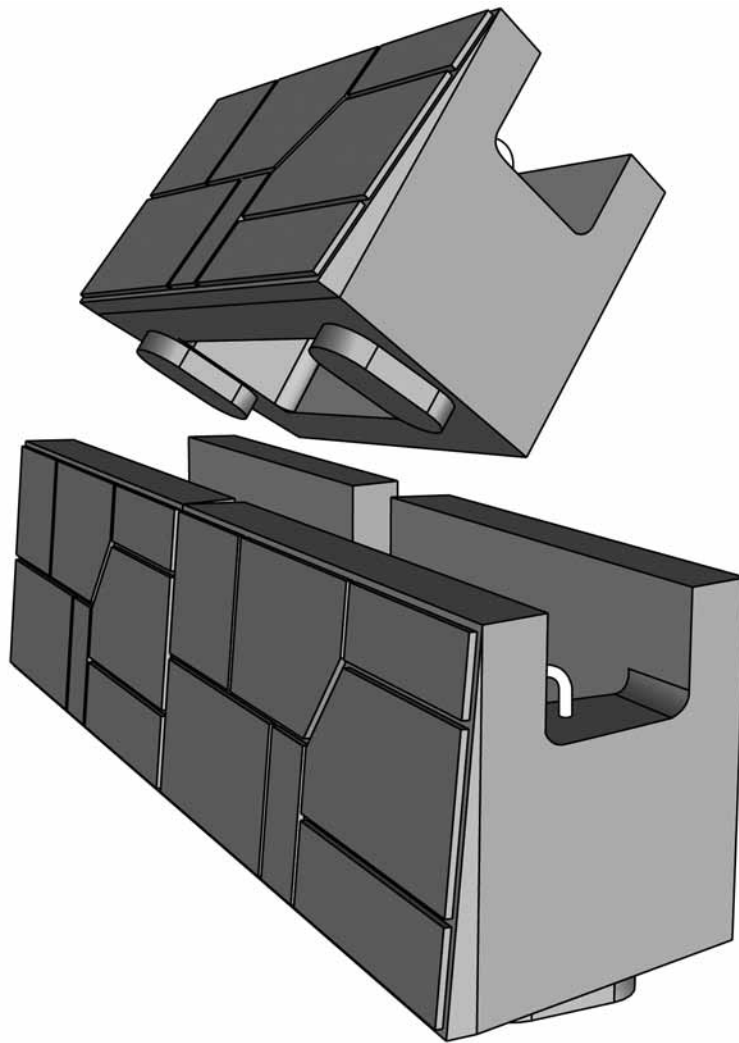

Our MagnumStone™ product is a large block, hollow core, wet-cast segmental retaining wall system that uses nearly half the amount of concrete per face foot when compared to traditional solid systems. The environmental and economical advantages of the pre-cast hollow block MagnumStone™ product are unprecedented in the retaining wall industry. Because of its size and design flexibility, MagnumStone™ is ideal for almost any retaining wall project from residential to large commercial installations.

Unit to unit connection uses our patented, mortarless, SecureLug™ interlock system (no expensive, time consuming pins or clips.) and are light enough that they can be moved two at a time with lighter machinery such as a standard Bobcat.

A wet cast segmental retaining wall product provides freeze/thaw durability advantages over competing products, a critical factor for the Departments Of Transport work that MagnumStone™ is very well suited for. The wet-cast process also allows for unique through-wall applications, face options and logo details for any type of project.

The System	2
The Units	3
Standard Unit	4
Standard Base Unit	5
Standard Top Unit	6
Half High Unit	7
Half High Base Unit	8
Half High Top Unit	9
Corner/End Units	10
Step/Cap Unit	11
Pillar & Pillar Cap Unit	12
Double Sided Unit	13
Gravity Wall	14
Gravity Wall Charts	15
Double Deep Gravity Wall	16
Double Deep Gravity Wall Charts	17
2.0 Ft Plantable Wall	18
2.0 Ft Plantable Wall Charts	19
4.0 Ft Plantable Wall	20
4.0 Ft Plantable Wall Charts	21
6.0 Ft Plantable Wall	22
6.0 Ft Plantable Wall Charts	23
Geogrid Friction Wall	24
Positive Connection Wall	25
Steel/Concrete Wall	26
Free Standing Double Sided Wall	27
Interlock/Drainage	28
Top of Wall Detail	29

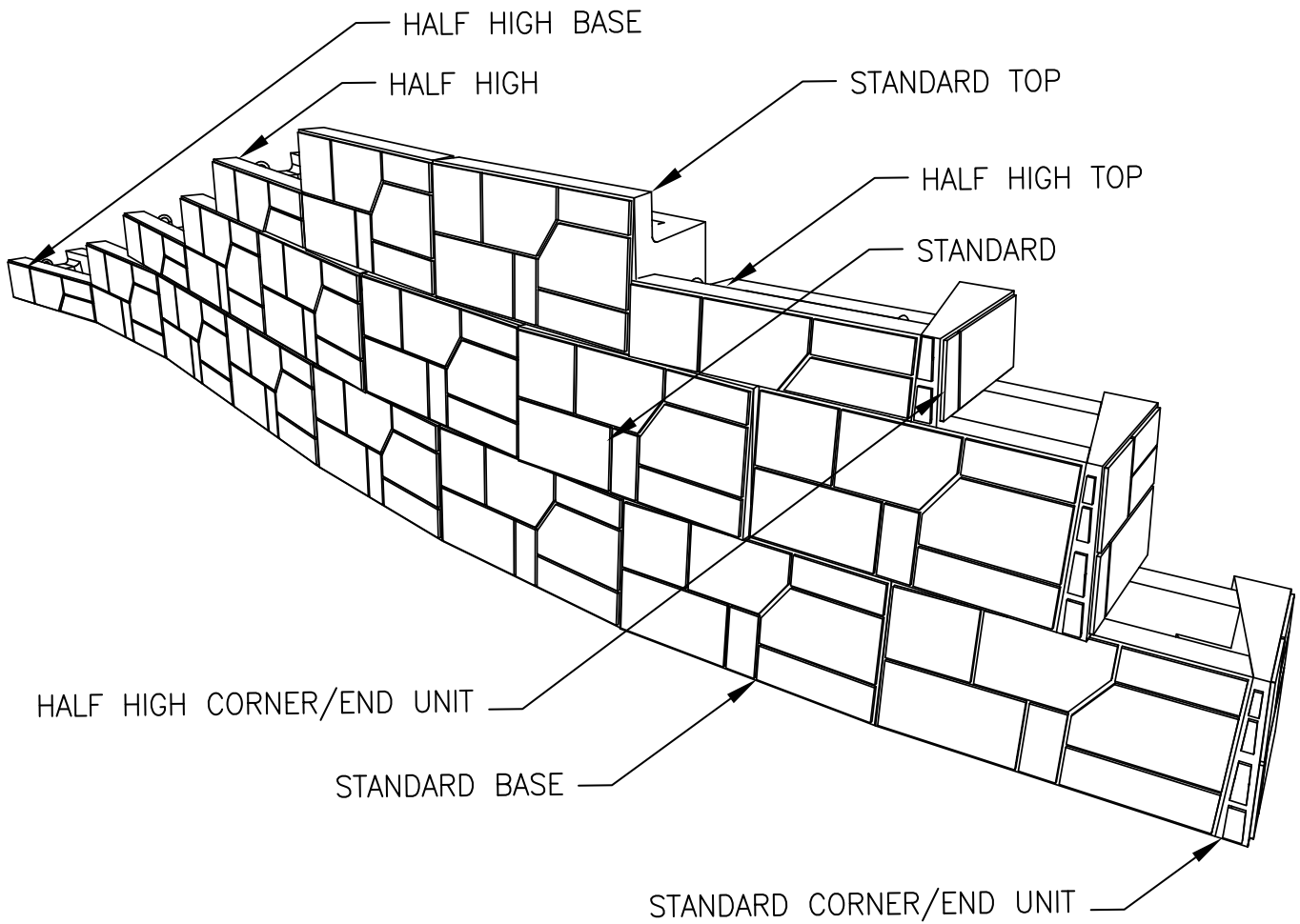

> > > MagnumStone™ Units

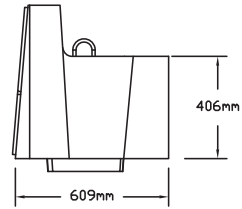
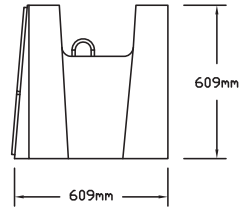
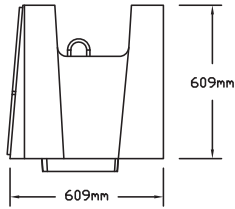
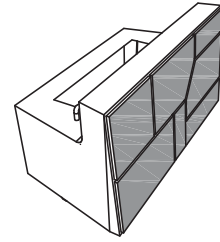
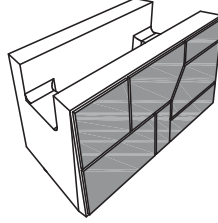
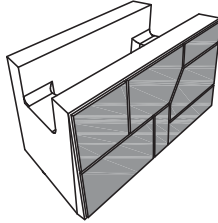

>>>STANDARD

>>>STANDARD BASE

>>>STANDARD TOP

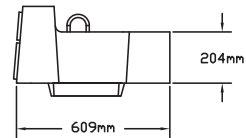
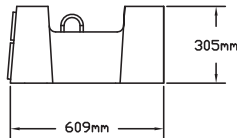
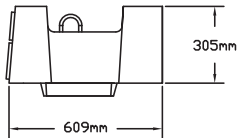
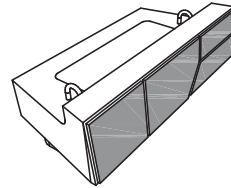
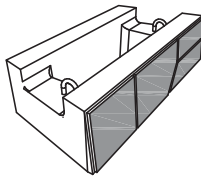
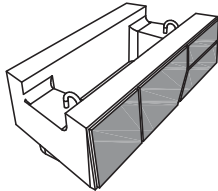

>>>HALF HIGH

>>>HALF HIGH BASE

>>>HALF HIGH TOP

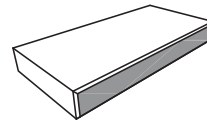
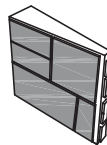
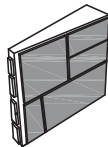

>>>STANDARD CORNER/END UNIT LEFT & RIGHT

>>>STEP/CAP

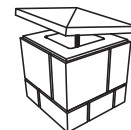
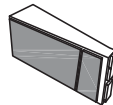
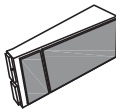

>>>HALF HIGH CORNER/END UNIT LEFT & RIGHT

>>>PILLAR

Weights and dimensions are nominal. Specifications may change. Verify exact information with your local producer.

>>> MagnumStone™ Standard Unit

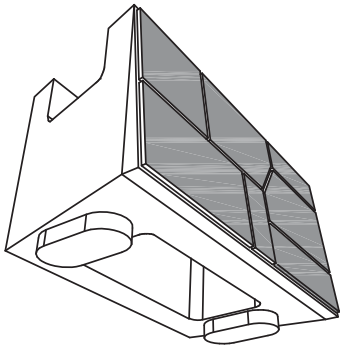

>>> ISOMETRIC BOTTOM VIEW

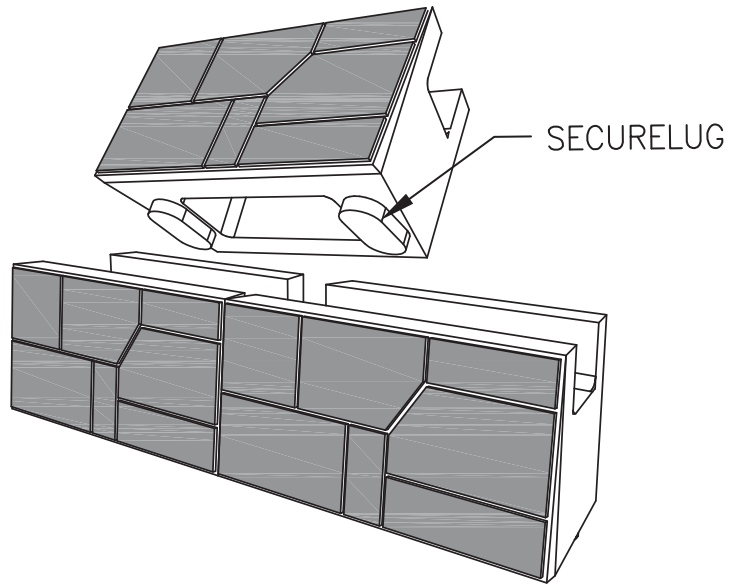

SECURELUG

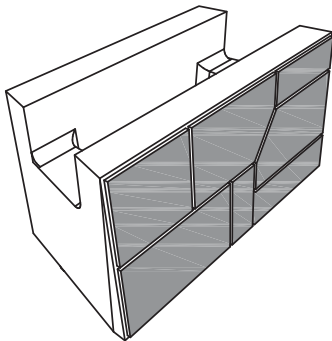

>>> ISOMETRIC TOP VIEW

Dimensions

Face Width	1219mm
Back Width	991mm
Depth	610mm
Height	610mm
Face Area	0.74 sq m
Batter	2.0"/Unit
Vertical	0"/Unit
Weight	621Kg
SecureLug	152x305x51mm

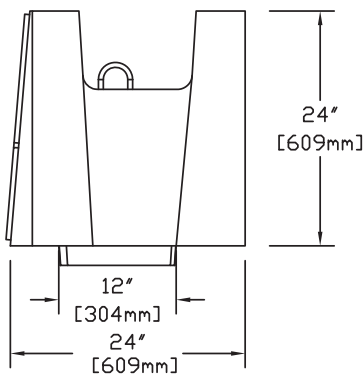

>>> SIDE VIEW

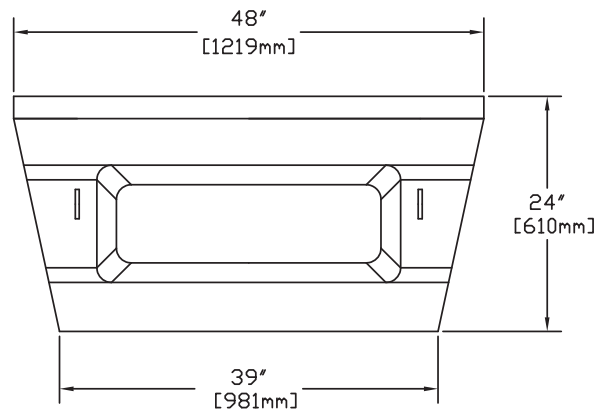

>>> TOP VIEW

Weights and dimensions are nominal. Specifications may change. Verify exact information with your local producer.

MagnumStone™ Technical Reference | © Magnum Forms Inc. | magnumforms.ca

> > > MagnumStone™ Standard Base Unit

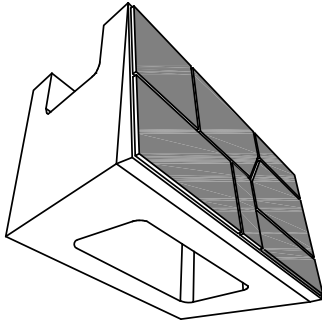

>>> ISOMETRIC BOTTOM VIEW

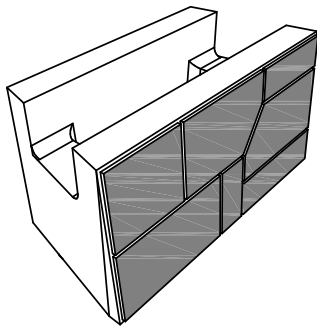
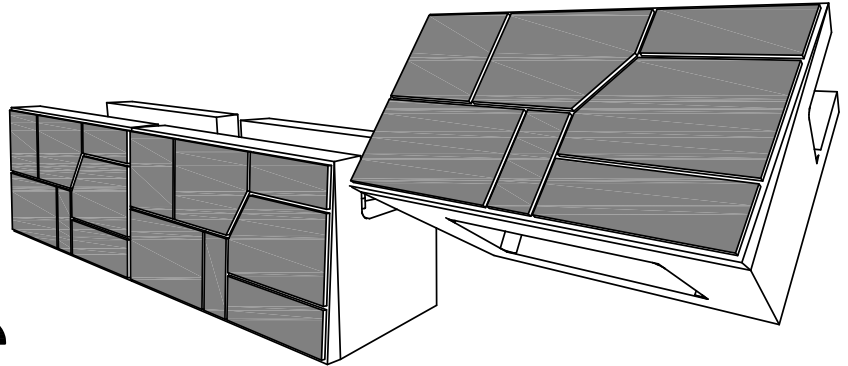

>>> ISOMETRIC TOP VIEW

Dimensions

Face Width	48"	1219mm
Back Width	39"	991mm
Depth	24"	610mm
Height	24"	610mm
Face Area	8 sq ft	0.74 sq m
Batter	4.5°	2.0"/Unit
Vertical	0°	0"/Unit
Weight	1345lbs	621Kg

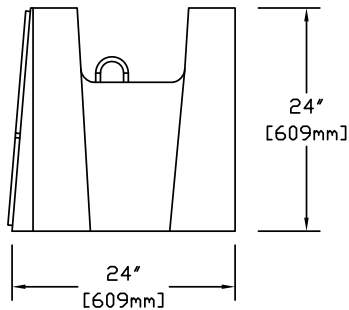

>>> SIDE VIEW

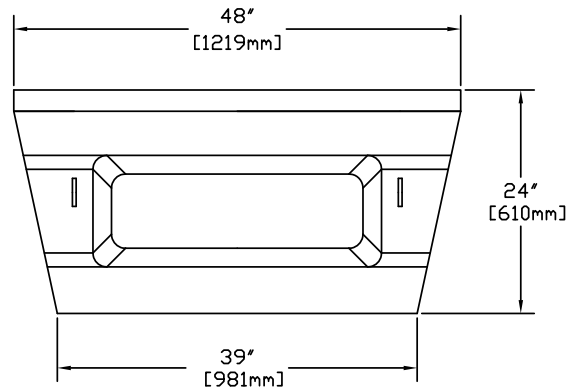

>>> TOP VIEW

Weights and dimensions are nominal. Specifications may change. Verify exact information with your local producer.

>>> MagnumStone™ Standard Top Unit

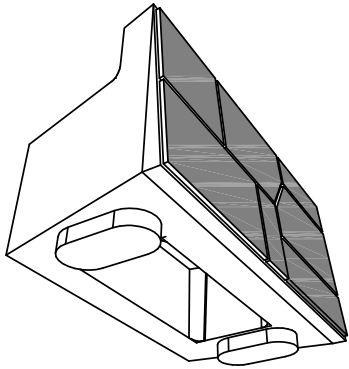

>>> ISOMETRIC BOTTOM VIEW

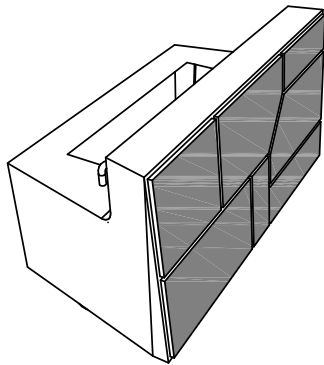
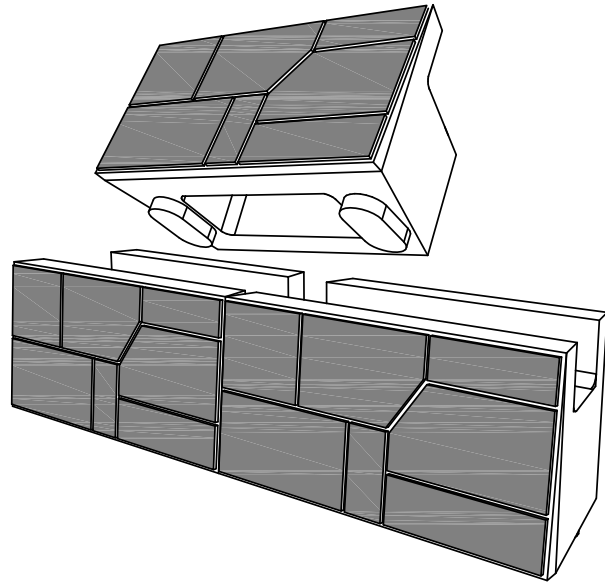

>>> ISOMETRIC TOP VIEW

Dimensions

Face Width	48"	1219mm
Back Width	39"	991mm
Depth	24"	610mm
Height	24"	610mm
Face Area	8 sq ft	0.74 sq m
Batter	4.5°	2.0"/Unit
Vertical	0°	0"/Unit
Weight	1220lbs	553Kg

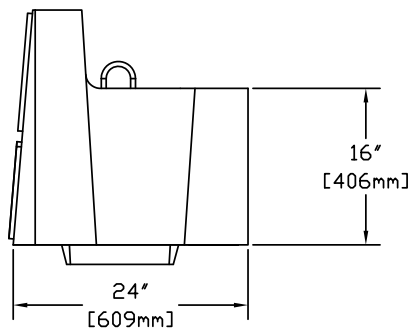

>>> SIDE VIEW

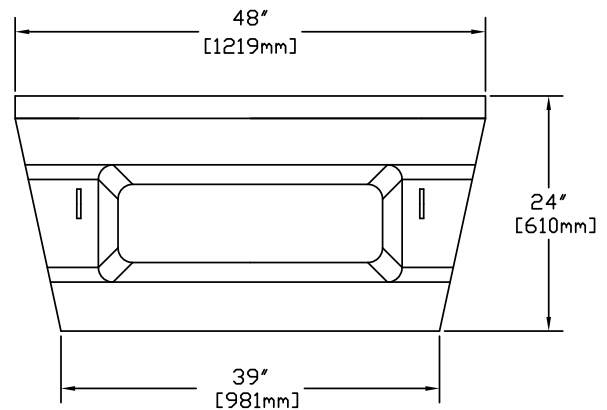

>>> TOP VIEW

Weights and dimensions are nominal. Specifications may change. Verify exact information with your local producer.

MagnumStone™ Technical Reference | © Magnum Forms Inc. | magnumforms.ca

> > > MagnumStone™ Half High Unit

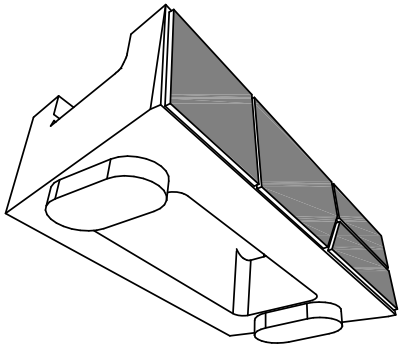

>>> ISOMETRIC BOTTOM VIEW

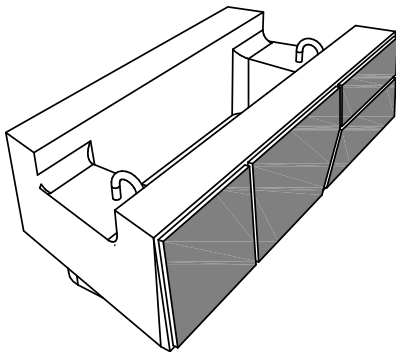
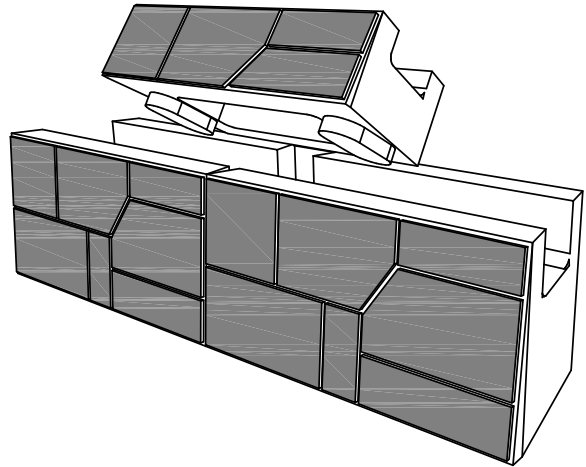

>>> ISOMETRIC TOP VIEW

Dimensions

Face Width	48"	1219mm
Back Width	39"	991mm
Depth	24"	610mm
Height	12"	305mm
Face Area	4 sq ft	0.37sq m
Batter	4.5°	1.0"/Unit
Vertical	0°	0"/Unit
Weight	750lbs	340Kg

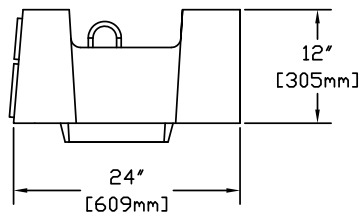

>>> SIDE VIEW

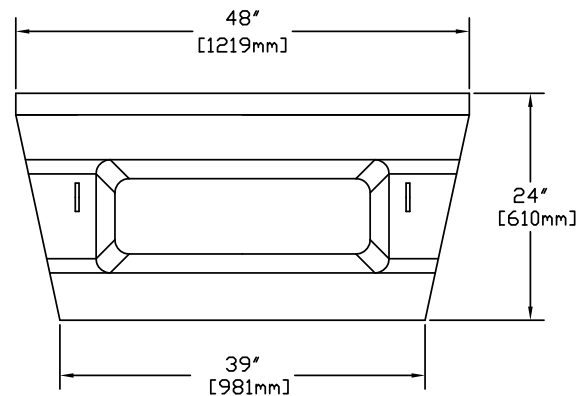

>>> TOP VIEW

Weights and dimensions are nominal. Specifications may change. Verify exact information with your local producer.

> > > MagnumStone™ Half High Base Unit

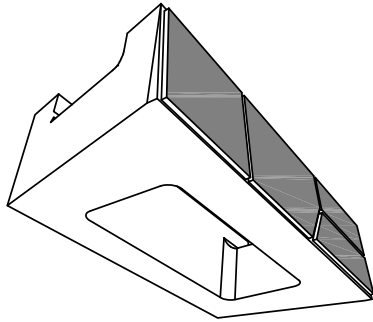

>>> ISOMETRIC BOTTOM VIEW

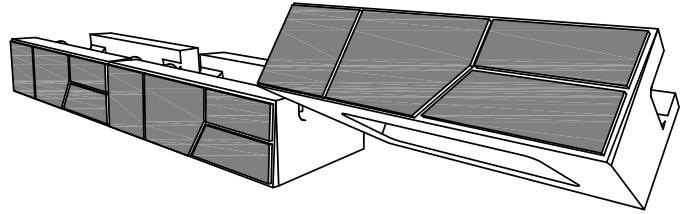

Dimensions

Face Width	48"	1219mm
Back Width	39"	991mm
Depth	24"	610mm
Height	12"	305mm
Face Area	4 sq ft	0.37sq m
Batter	4.5°	1.0"/Unit
Vertical	0°	0"/Unit
Weight	725lbs	328Kg

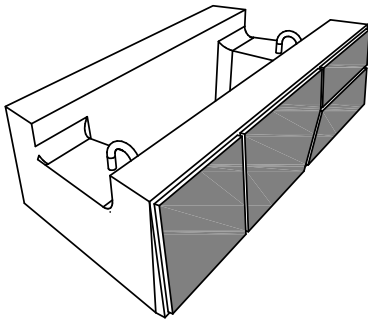

>>> ISOMETRIC TOP VIEW

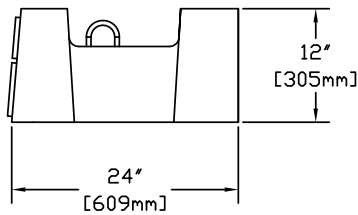

>>> SIDE VIEW

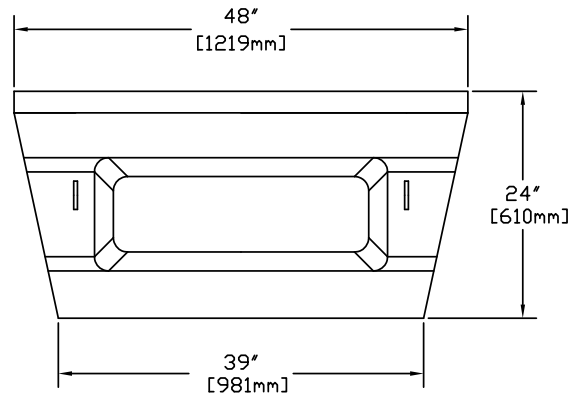

>>> TOP VIEW

Weights and dimensions are nominal. Specifications may change. Verify exact information with your local producer.

MagnumStone™ Technical Reference | © Magnum Forms Inc. | magnumforms.ca

> > > MagnumStone™ Half High Top Unit

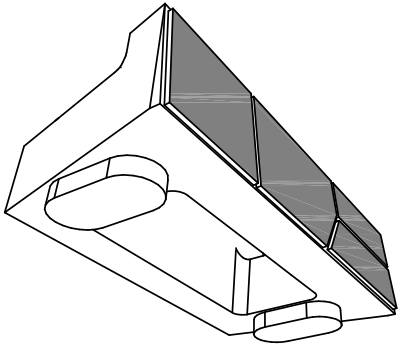

>>> ISOMETRIC BOTTOM VIEW

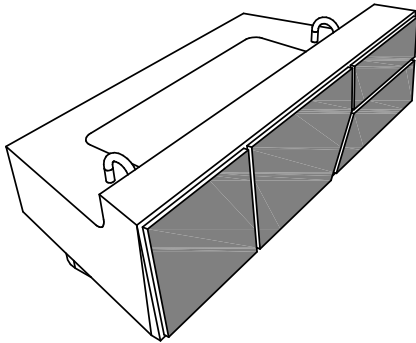
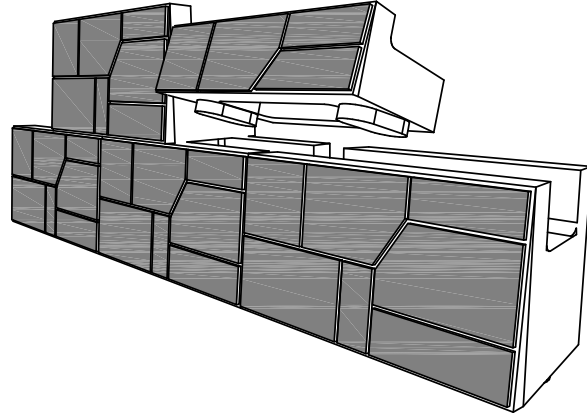

>>> ISOMETRIC TOP VIEW

Dimensions

Face Width	48"	1219mm
Back Width	39"	991mm
Depth	24"	305mm
Height	12"	610mm
Face Area	4 sq ft	0.37sq m
Batter	4.5°	1.0"/Unit
Vertical	0°	0"/Unit
Weight	680lbs	308Kg

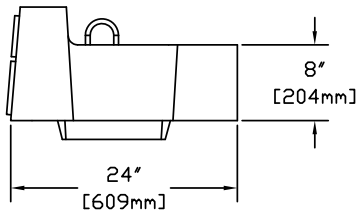

>>> SIDE VIEW

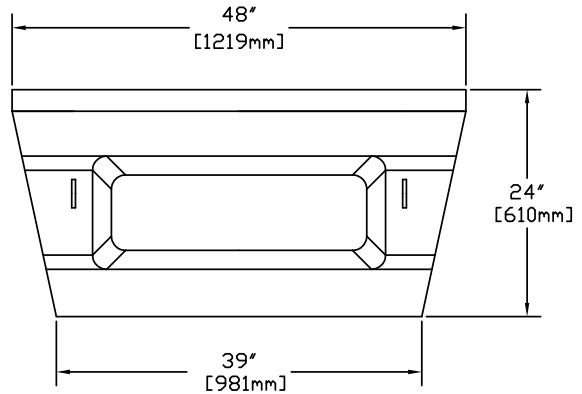

>>> TOP VIEW

Weights and dimensions are nominal. Specifications may change. Verify exact information with your local producer.

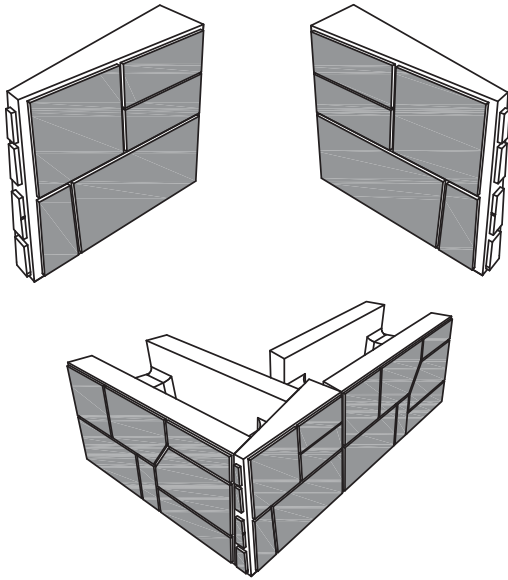

Dimensions

Top Face Width	26"	660mm
Bottom Face Width	28"	711mm
Top Narrow Face	2"	51mm
Bottom Narrow Face	4"	102mm
Height	24"	610mm
Face Area	4.66sq ft	0.434 sq m
Batter	4.5°	2.0"/Unit
Vertical	0°	0"/Unit
Weight	340lbs	154Kg

>>>STANDARD CORNER/END UNIT

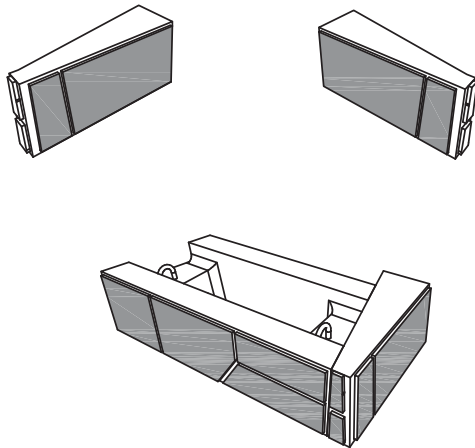

Dimensions

Top Face Width	27"	686mm
Bottom Face Width	28"	711mm
Top Narrow Face	3"	76mm
Bottom Narrow Face	4"	102mm
Height	24"	610mm
Face Area	2.33sq ft	0.217 sq m
Batter	4.5°	1.0"/Unit
Vertical	0°	0"/Unit
Weight	170lbs	77Kg

>>>HALF HIGH CORNER/END UNIT

Weights and dimensions are nominal. Specifications may change. Verify exact information with your local producer.

> > > MagnumStone™ Step/Cap Unit

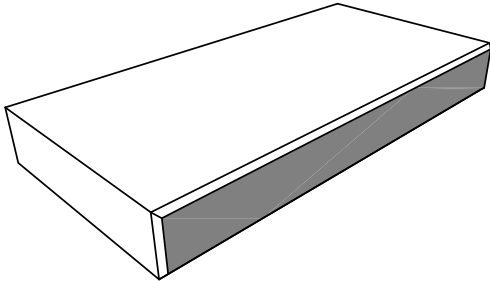

>>> ISOMETRIC BOTTOM VIEW

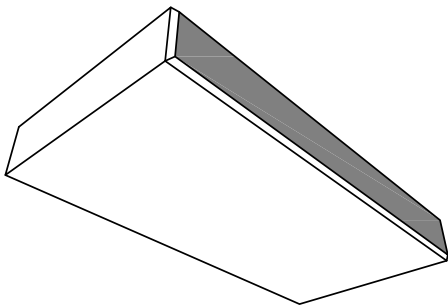
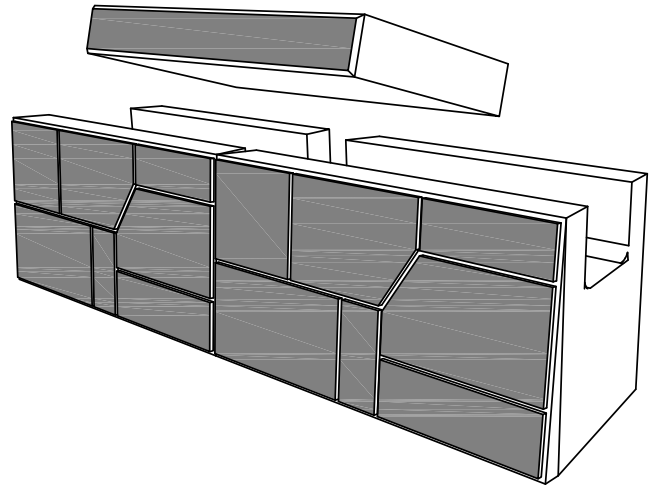

>>> ISOMETRIC TOP VIEW

Dimensions

Face Width	48"	1219mm
Back Width	48"	1219mm
Depth	24"	610mm
Height	6"	152mm
Face Area	2 sq ft	0.186 sq m
Weight	290lbs	131Kg

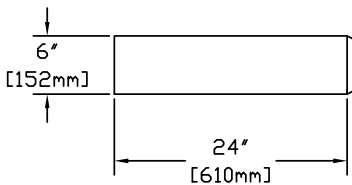

>>> SIDE VIEW

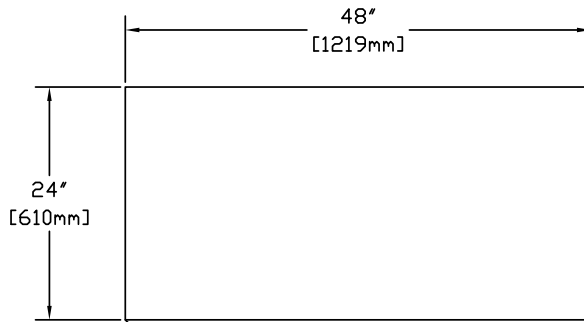

>>> TOP VIEW

Weights and dimensions are nominal. Specifications may change. Verify exact information with your local producer.

>>> MagnumStone™ Pillar & Pillar Cap Unit

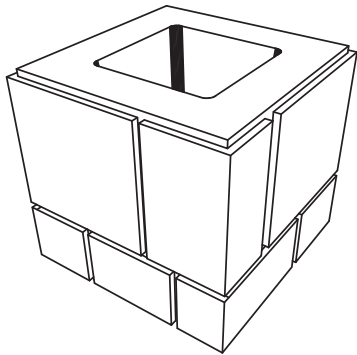

>>> ISOMETRIC BOTTOM VIEW

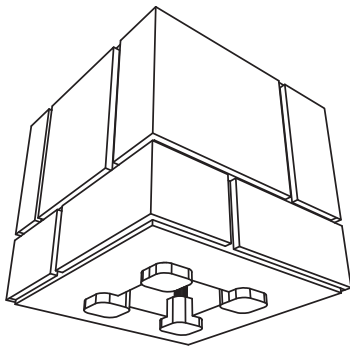
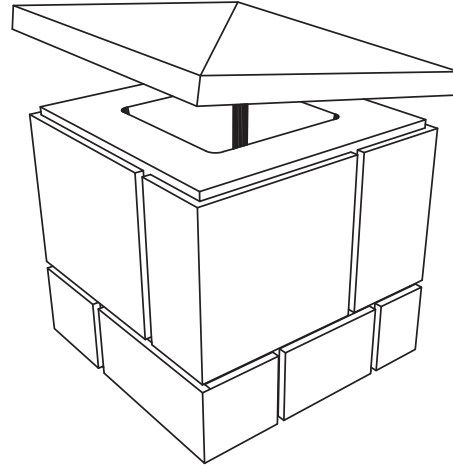

>>> ISOMETRIC TOP VIEW

Dimensions

Face Widths	24"	610mm
Height	24"	610mm
Face Area	4 sq ft	0.37 sq m
Batter	0°	0"/Unit
Weight	870lbs	394Kg

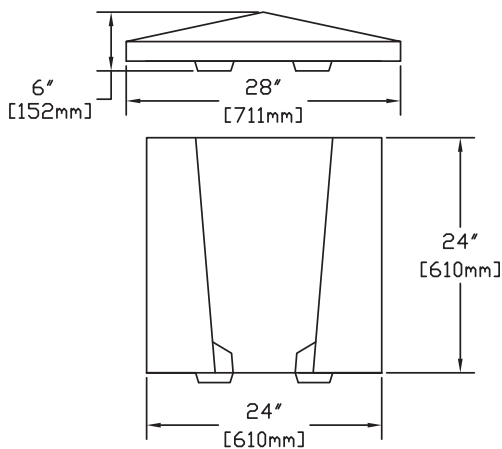

>>> SIDE VIEW

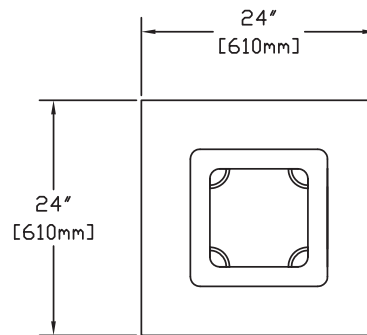

>>> TOP VIEW

DISCLAIMER: This product is not available in all areas.

Weights and dimensions are nominal. Specifications may change. Verify exact information with your local producer.

MagnumStone™ Technical Reference | © Magnum Forms Inc. | magnumforms.ca

> > > MagnumStone™ Double Sided Unit

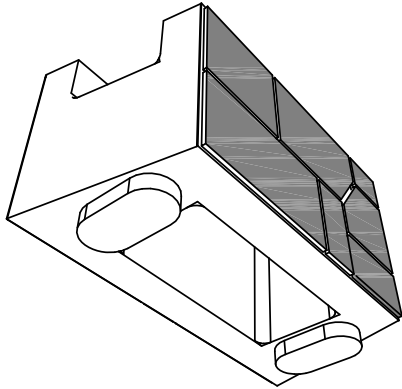

>>> ISOMETRIC BOTTOM VIEW

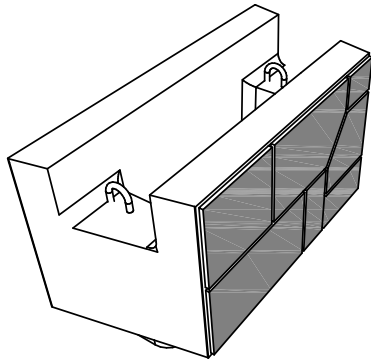
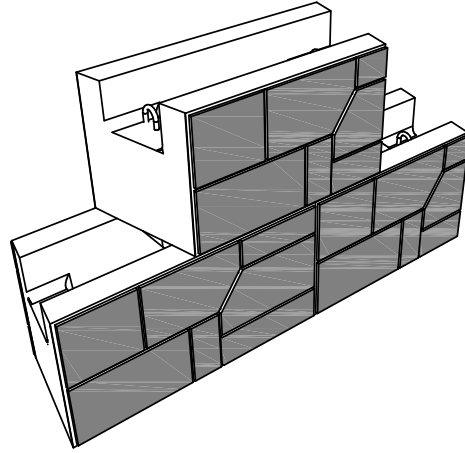

>>> ISOMETRIC TOP VIEW

Dimensions

Face Width	48"	1219mm
Back Width	39"	991mm
Depth	22"	559mm
Height	24"	610mm
Face Area	4 sq ft	0.37sq m
Vertical	0°	0"/Unit
Weight	1345lbs	625Kg

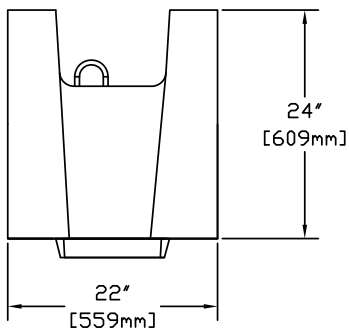

>>> SIDE VIEW

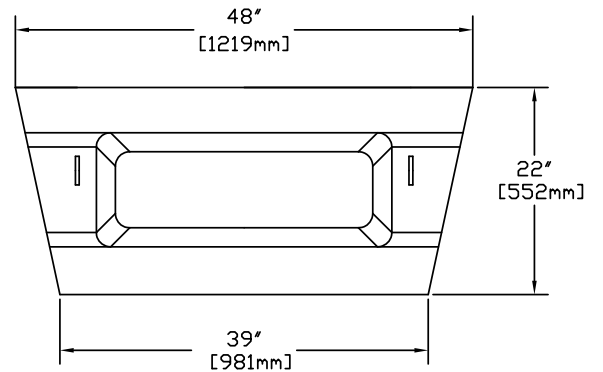

>>> TOP VIEW

Weights and dimensions are nominal. Specifications may change. Verify exact information with your local producer.

> > > MagnumStone™ Gravity Wall

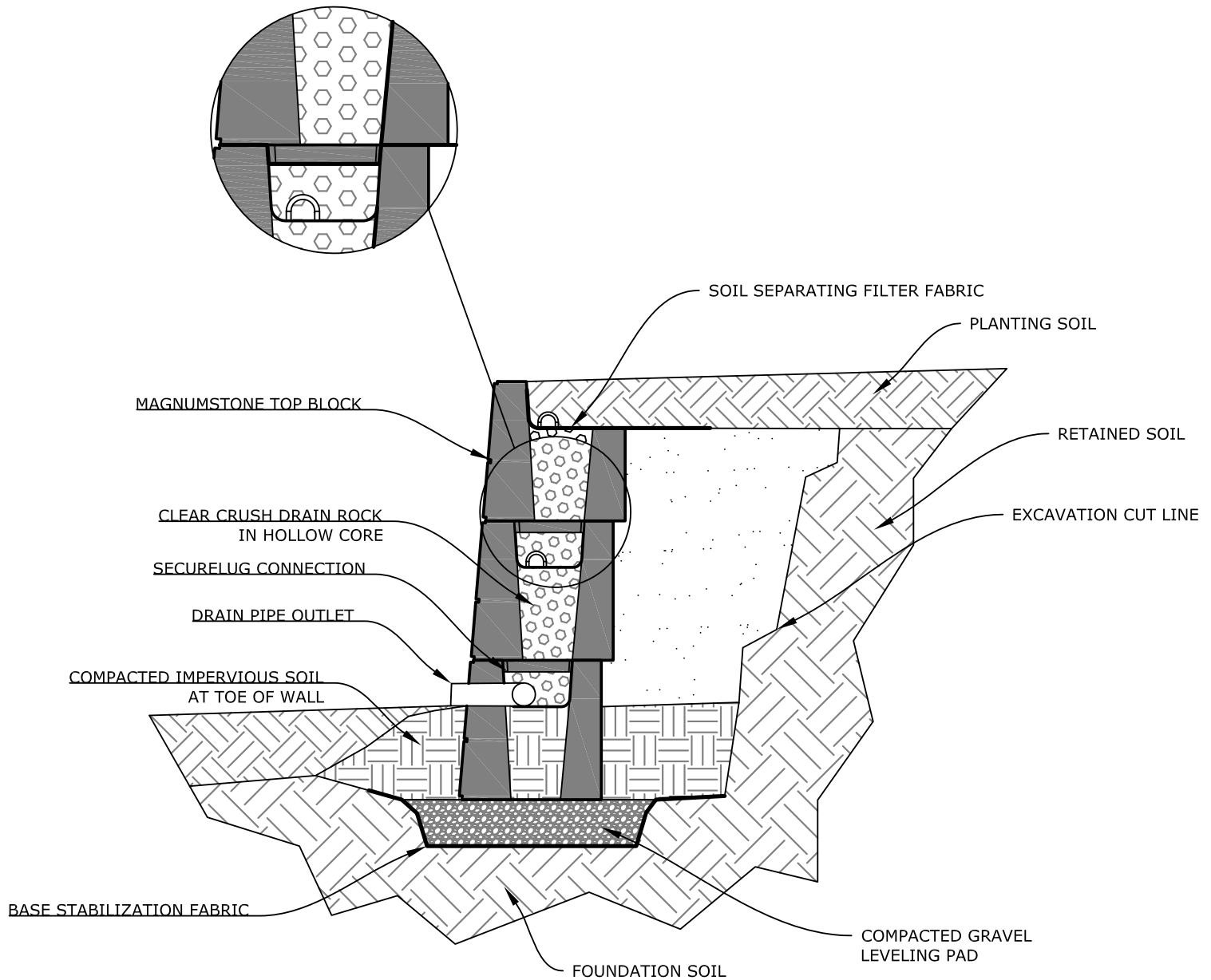

> > > MagnumStone™ Gravity Wall Charts

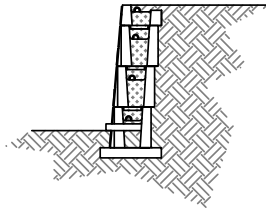

Soil Type	Height Exposed	Height Embedded	Total
AASHTO #57	8.1' (2469mm)	0.5' (152mm)	8.6' (2621mm)
34° Soil	6.6' (2012mm)	0.5' (152mm)	7.1' (2164mm)
30° Soil	5.9' (1798mm)	0.5' (152mm)	6.4' (1951mm)
26° Soil	4.9' (1494mm)	0.5' (152mm)	5.4' (1646mm)

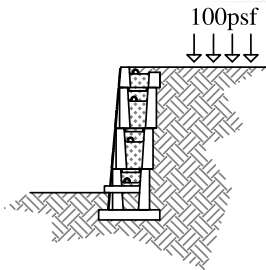

Soil Type	Height Exposed	Height Embedded	Total
AASHTO #57	6.6' (2012mm)	0.5' (152mm)	7.1' (2164mm)
34° Soil	5.4' (1646mm)	0.5' (152mm)	5.9' (1798mm)
30° Soil	4.4' (1341mm)	0.5' (152mm)	4.9' (1494mm)
26° Soil	3.3' (1006mm)	0.5' (152mm)	3.8' (1158mm)

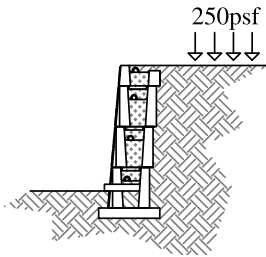

Soil Type	Height Exposed	Height Embedded	Total
AASHTO #57	4.9' (1494mm)	0.5' (152mm)	5.4' (1646mm)
34° Soil	3.3' (1006mm)	0.5' (152mm)	3.8' (1158mm)
30° Soil	2.0' (610mm)	0.5' (152mm)	2.5' (762mm)
26° Soil	0.9' (274mm)	0.5' (152mm)	1.4' (427mm)

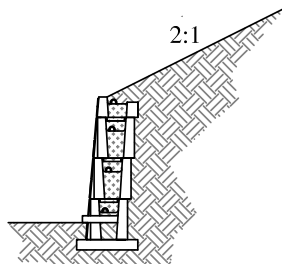

Soil Type	Height Exposed	Height Embedded	Total
AASHTO #57	6.5' (1981mm)	0.5' (152mm)	7.0' (2134mm)
34° Soil	4.5' (1372mm)	0.5' (152mm)	5.0' (1524mm)
30° Soil	3.2' (975mm)	0.5' (152mm)	3.7' (1128mm)
26° Soil			

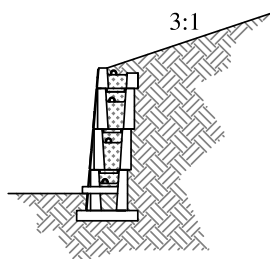

Soil Type	Height Exposed	Height Embedded	Total
AASHTO #57	7.1' (2164mm)	0.5' (152mm)	7.6' (2316mm)
34° Soil	5.6' (1707mm)	0.5' (152mm)	6.1' (1859mm)
30° Soil	4.4' (1341mm)	0.5' (152mm)	4.9' (1494mm)
26° Soil	3.3' (1006mm)	0.5' (152mm)	3.8' (1158mm)

DISCLAIMER. This chart is for initial estimation purposes only. Do not use for final design or construction. Retain a licensed professional engineer to design every wall on a case-by-case basis using site specific criteria. The accuracy and use of this document are the sole responsibility of the user. All calculations were performed based on NCMA methodology using factors of safety of 1.5 for sliding and overturning. The bearing capacity of base soils will be no less than 3,000 pounds per square foot (psf). All soils have been assumed to be less than 125 pounds per cubic foot (pcf). Global Stability Analysis has not been performed.

> > > MagnumStone™ Double Deep Gravity Wall

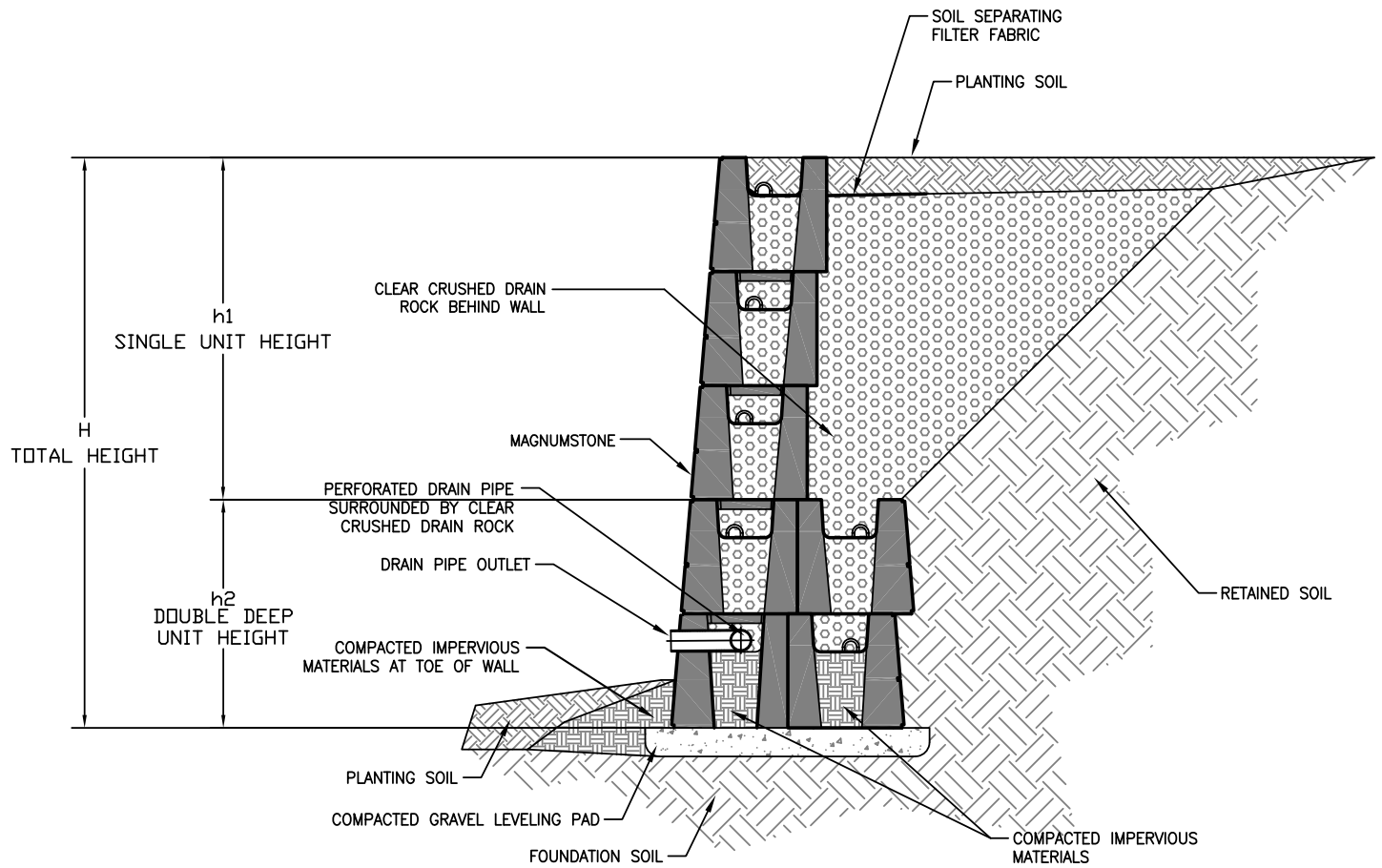

DISCLAIMER. This chart is for initial estimation purposes only. Do not use for final design or construction. Retain a licensed professional engineer to design every wall on a case-by-case basis using site specific criteria. The accuracy and use of this document are the sole responsibility of the user. All calculations were performed based on NCMA methodology using factors of safety of 1.5 for sliding and overturning. The bearing capacity of base soils will be no less than 3,000 pounds per square foot (psf). All soils have been assumed to be less than 125 pounds per cubic foot (pcf). Global Stability Analysis has not been performed.

> > > MagnumStone™ Double Deep Gravity Wall Charts

Lower Tier (AASHTO #57) Upper Tier (AASHTO #57)
 $\phi_{soil} = 38^\circ$ (min.) $\phi_{soil} = 38^\circ$ (min.)
 $\gamma_{soil} = 110\text{pcf}$ (max.) $\gamma_{soil} = 110\text{pcf}$ (max.)

No Slope, No Load

H	h1	h2
16' (4877mm)	0' (0mm)	16' (4877mm)
14' (4267mm)	2' (610mm)	12' (3658mm)
12' (3658mm)	5' (1524mm)	7' (2134mm)
10' (3048mm)	8' (2438mm)	3' (914mm)
9' (2134mm)	9' (2134mm)	0' (0mm)

2:1 Slope, No Load

H	h1	h2
14' (4267mm)	0' (0mm)	14' (4267mm)
12' (3658mm)	1' (305mm)	11' (3353mm)
10' (3048mm)	4' (1219mm)	6' (1829mm)
8' (2438mm)	6' (1829mm)	2' (610mm)
7' (2134mm)	7' (2134mm)	0' (0mm)

3:1 Slope, No Load

H	h1	h2
15' (4572mm)	0' (0mm)	15' (4572mm)
14' (4267mm)	0' (0mm)	14' (4267mm)
12' (3658mm)	3' (914mm)	9' (2743mm)
10' (3048mm)	5' (1524mm)	5' (1524mm)
8' (2438mm)	7' (2134mm)	1' (305mm)
8' (2438mm)	8' (2438mm)	0' (0mm)

No Slope, 100psf Load

H	h1	h2
16' (4877mm)	0' (0mm)	16' (4877mm)
14' (4267mm)	1' (305mm)	13' (3962mm)
12' (3658mm)	3' (914mm)	9' (2743mm)
10' (3048mm)	6' (1829mm)	5' (1524mm)
8' (2438mm)	7' (2134mm)	1' (305mm)
7' (2134mm)	7' (2134mm)	0' (0mm)

No Slope, 250psf Load

H	h1	h2
14' (4267mm)	0' (0mm)	14' (4267mm)
12' (3658mm)	1' (305mm)	11' (3353mm)
10' (3048mm)	3' (914mm)	7' (2134mm)
8' (2438mm)	5' (1524mm)	3' (914mm)
6' (1829mm)	6' (1829mm)	0' (0mm)
5' (1524mm)	5' (1524mm)	0' (0mm)

Lower Tier Upper Tier (AASHTO #57)
 $\phi_{soil} = 30^\circ$ (min.) $\phi_{soil} = 38^\circ$ (min.)
 $\gamma_{soil} = 125\text{pcf}$ (max.) $\gamma_{soil} = 110\text{pcf}$ (max.)

No Slope, No Load

H	h1	h2
13' (3962mm)	0' (0mm)	13' (3962mm)
12' (3658mm)	2' (610mm)	10' (3048mm)
10' (3048mm)	4' (1219mm)	6' (1829mm)
8' (2438mm)	6' (1829mm)	3' (914mm)
6' (1829mm)	6' (1829mm)	0' (0mm)

2:1 Slope, No Load

H	h1	h2
7' (2134mm)	0' (0mm)	7' (2134mm)
7' (2134mm)	3' (914mm)	4' (1219mm)
6' (1829mm)	4' (1219mm)	2' (610mm)
4' (1219mm)	4' (1219mm)	1' (305mm)
4' (1219mm)	4' (1219mm)	0' (mm)

3:1 Slope, No Load

H	h1	h2
10' (3048mm)	0' (0mm)	10' (3048mm)
8' (2438mm)	4' (1219mm)	4' (1219mm)
6' (1829mm)	5' (1524mm)	1' (305mm)
5' (1524mm)	5' (1524mm)	0' (0mm)

No Slope, 100psf Load

H	h1	h2
11' (3353mm)	0' (0mm)	11' (3353mm)
10' (3048mm)	1' (305mm)	9' (2743mm)
8' (2438mm)	4' (1219mm)	4' (1219mm)
6' (1829mm)	5' (1524mm)	1' (305mm)
5' (1524mm)	5' (1524mm)	0 (0mm)

No Slope, 250psf Load

H	h1	h2
9' (2743mm)	0' (0mm)	9' (2743mm)
8' (2438mm)	3' (914mm)	5' (1524mm)
6' (1829mm)	4' (1219mm)	2' (610mm)
4' (1219mm)	3' (914mm)	1' (305mm)
3' (914mm)	3' (914mm)	0' (0mm)

> > > MagnumStone™ 2.0 Ft Plantable Wall

39° 

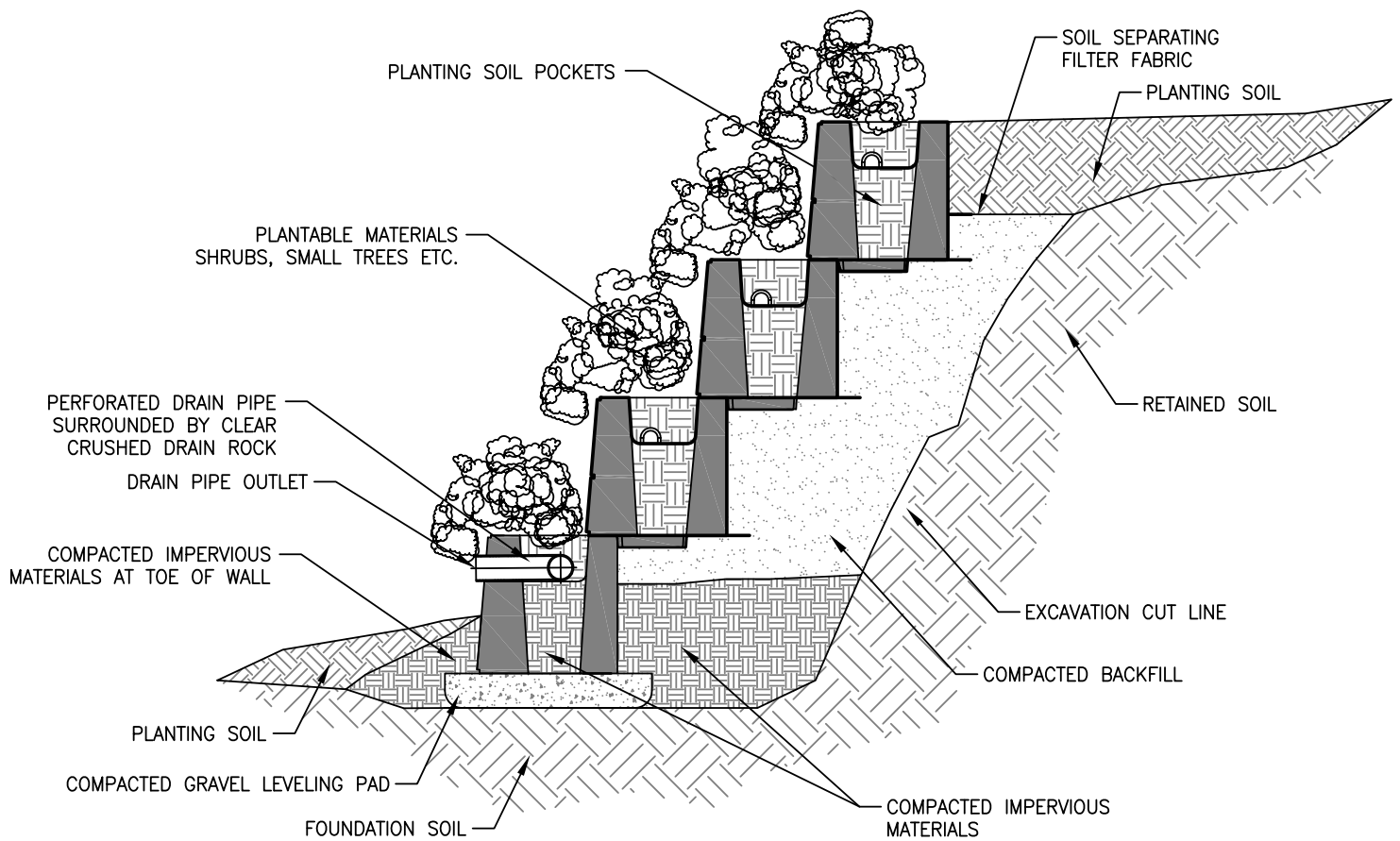

> > > MagnumStone™ 2.0 Ft Plantable Wall Charts

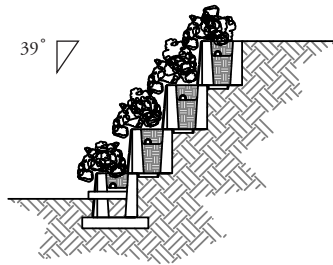

Soil Type	Height Exposed	Height Embedded	Total
34° Soil	20.9' (6370mm)	1.1' (335mm)	22.0' (6706mm)
30° Soil	20.9' (6370mm)	1.1' (335mm)	22.2' (6767mm)
26° Soil	14.5' (4420mm)	0.8' (244mm)	15.3' (4663mm)

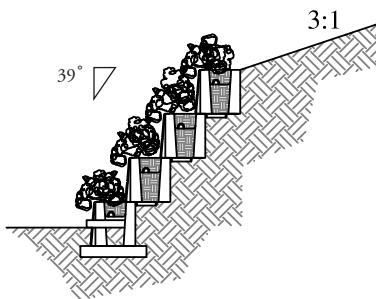

Soil Type	Height Exposed	Height Embedded	Total
34° Soil	20.9' (6370mm)	1.1' (335mm)	22.0' (6706mm)
30° Soil	17.8' (5425mm)	1.0' (305mm)	18.8' (5730mm)
26° Soil	10.8' (3292mm)	0.6' (183mm)	11.4' (3475mm)

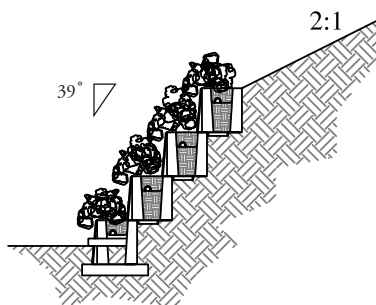

Soil Type	Height Exposed	Height Embedded	Total
34° Soil	20.9' (6370mm)	1.1' (335mm)	22.0' (6706mm)
30° Soil	13.4' (4084mm)	0.8' (244mm)	14.2' (4328mm)
26° Soil	N/A	N/A	N/A

DISCLAIMER. This chart is for initial estimation purposes only. Do not use for final design or construction. Retain a licensed professional engineer to design every wall on a case-by-case basis using site specific criteria. The accuracy and use of this document are the sole responsibility of the user. All calculations were performed based on NCMA methodology using factors of safety of 1.5 for sliding and overturning. The bearing capacity of base soils will be no less than 3,000 pounds per square foot (psf). All soils have been assumed to be less than 125 pounds per cubic foot (pcf). Global Stability Analysis has not been performed.

>>> MagnumStone™ 4.0 Ft Plantable Wall

25° 

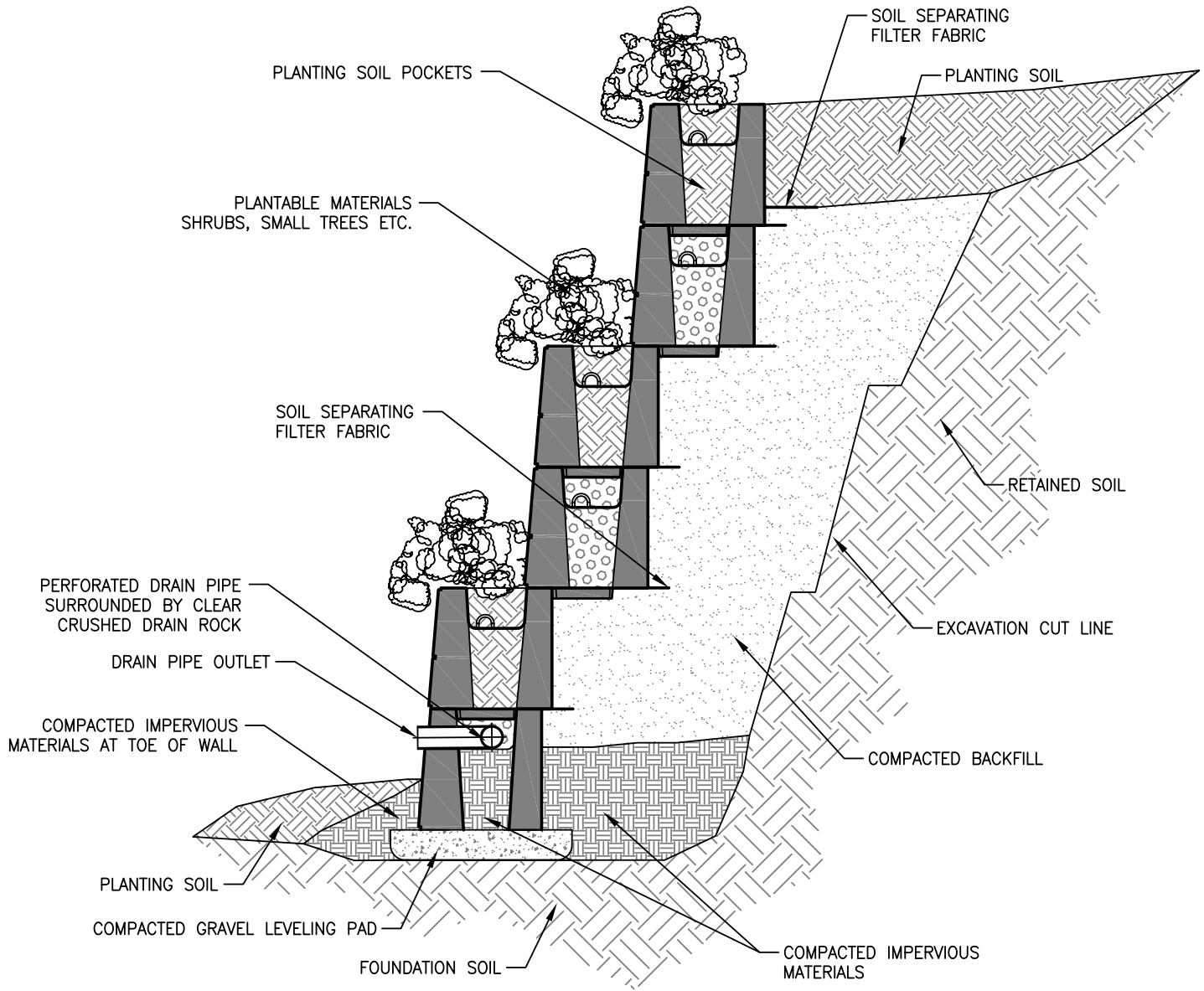

> > > MagnumStone™ 4.0 Ft Plantable Wall Charts

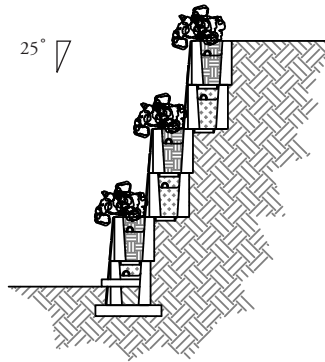

Soil Type	Height Exposed	Height Embedded	Total
34° Soil	14.5' (4420mm)	0.8' (244mm)	15.3' (4663mm)
30° Soil	10.8' (3292mm)	0.6' (183mm)	11.4' (3475mm)
26° Soil	8.1' (2469mm)	0.5' (152mm)	8.6' (2621mm)

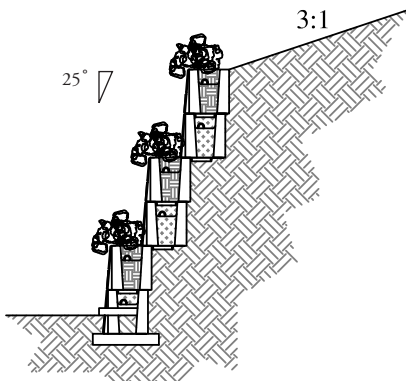

Soil Type	Height Exposed	Height Embedded	Total
34° Soil	11.8' (3597mm)	0.7' (213mm)	12.5' (3810mm)
30° Soil	8.4' (2560mm)	0.5' (152mm)	8.9' (2713mm)
26° Soil	5.8' (1768mm)	0.5' (152mm)	6.3' (1920mm)

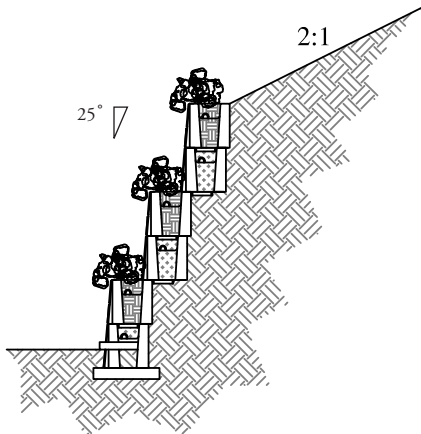

Soil Type	Height Exposed	Height Embedded	Total
34° Soil	9.8' (2987mm)	0.6' (183mm)	10.4' (3170mm)
30° Soil	6.2' (1890mm)	0.5' (152mm)	6.7' (2042mm)
26° Soil	N/A	N/A	N/A

DISCLAIMER. This chart is for initial estimation purposes only. Do not use for final design or construction. Retain a licensed professional engineer to design every wall on a case-by-case basis using site specific criteria. The accuracy and use of this document are the sole responsibility of the user. All calculations were performed based on NCMA methodology using factors of safety of 1.5 for sliding and overturning. The bearing capacity of base soils will be no less than 3,000 pounds per square foot (psf). All soils have been assumed to be less than 125 pounds per cubic foot (pcf). Global Stability Analysis has not been performed.

>>> MagnumStone™ 6.0 Ft Plantable Wall

18°

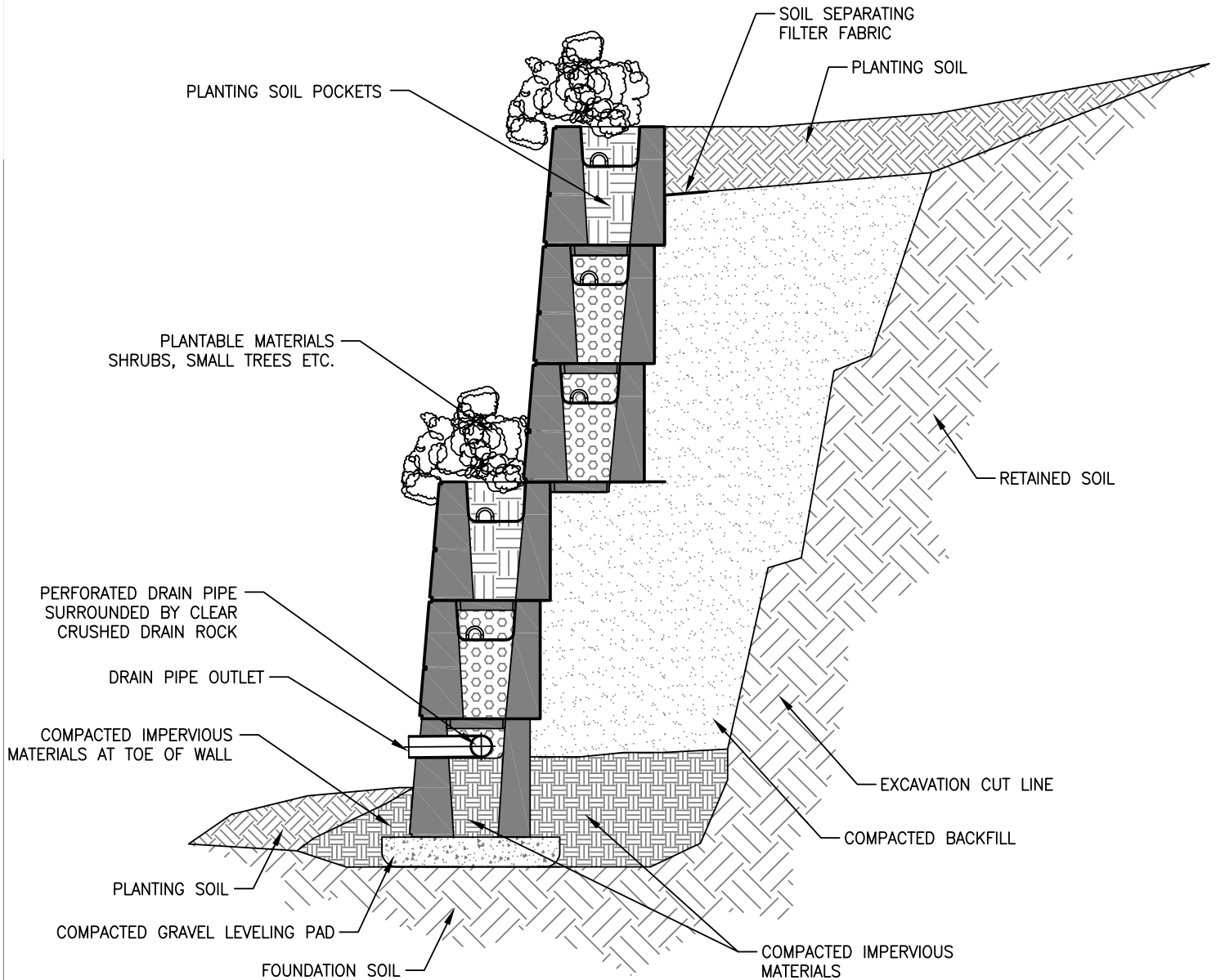

> > > MagnumStone™ 6.0 Ft Plantable Wall Charts

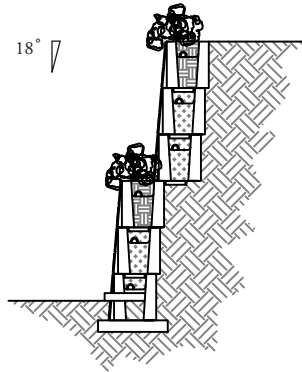

Soil Type	Height Exposed	Height Embedded	Total
34° Soil	10.9' (3322mm)	0.6' (183mm)	11.5' (3505mm)
30° Soil	8.5' (2591mm)	0.5' (152mm)	9.0' (2743mm)
26° Soil	6.6' (2012mm)	0.5' (152mm)	7.1' (2164mm)

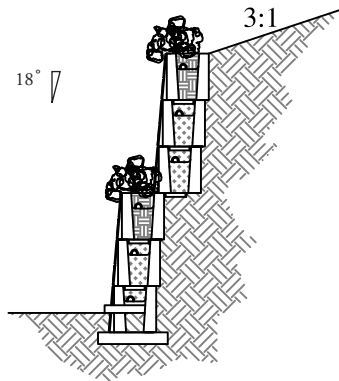

Soil Type	Height Exposed	Height Embedded	Total
34° Soil	8.8' (2682mm)	0.5' (152mm)	9.3' (2835mm)
30° Soil	6.4' (1951mm)	0.5' (152mm)	6.9' (2103mm)
26° Soil	4.7' (1433mm)	0.5' (152mm)	5.2' (1586mm)

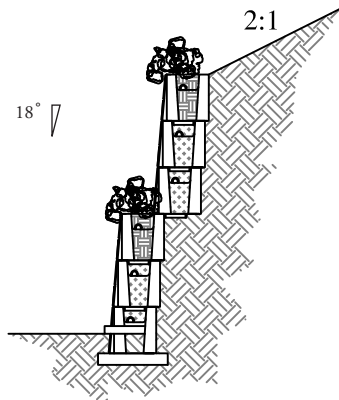

Soil Type	Height Exposed	Height Embedded	Total
34° Soil	7.2' (2195mm)	0.5' (152mm)	7.7' (2347mm)
30° Soil	4.8' (1463mm)	0.5' (152mm)	5.3' (1615mm)
26° Soil	N/A	N/A	N/A

DISCLAIMER. This chart is for initial estimation purposes only. Do not use for final design or construction. Retain a licensed professional engineer to design every wall on a case-by-case basis using site specific criteria. The accuracy and use of this document are the sole responsibility of the user. All calculations were performed based on NCMA methodology using factors of safety of 1.5 for sliding and overturning. The bearing capacity of base soils will be no less than 3,000 pounds per square foot (psf). All soils have been assumed to be less than 125 pounds per cubic foot (pcf). Global Stability Analysis has not been performed.

> > > MagnumStone™ Geogrid Friction Wall

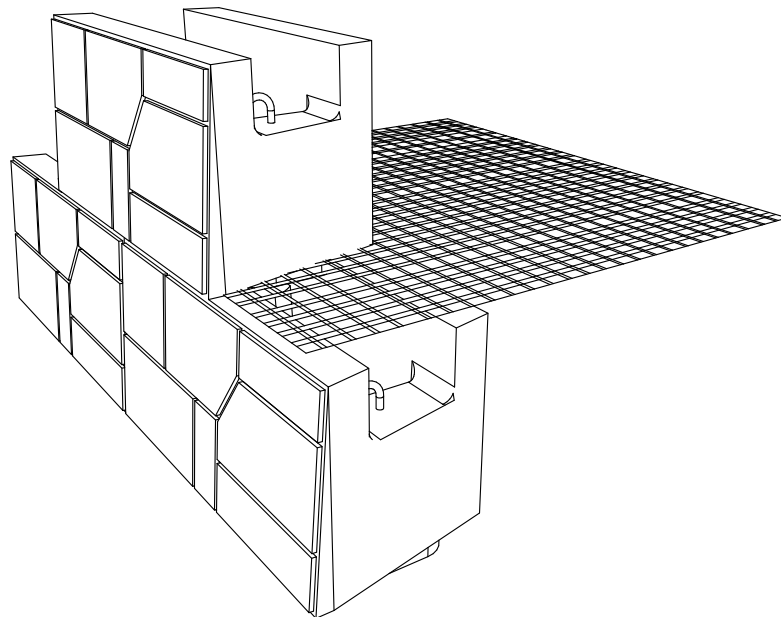
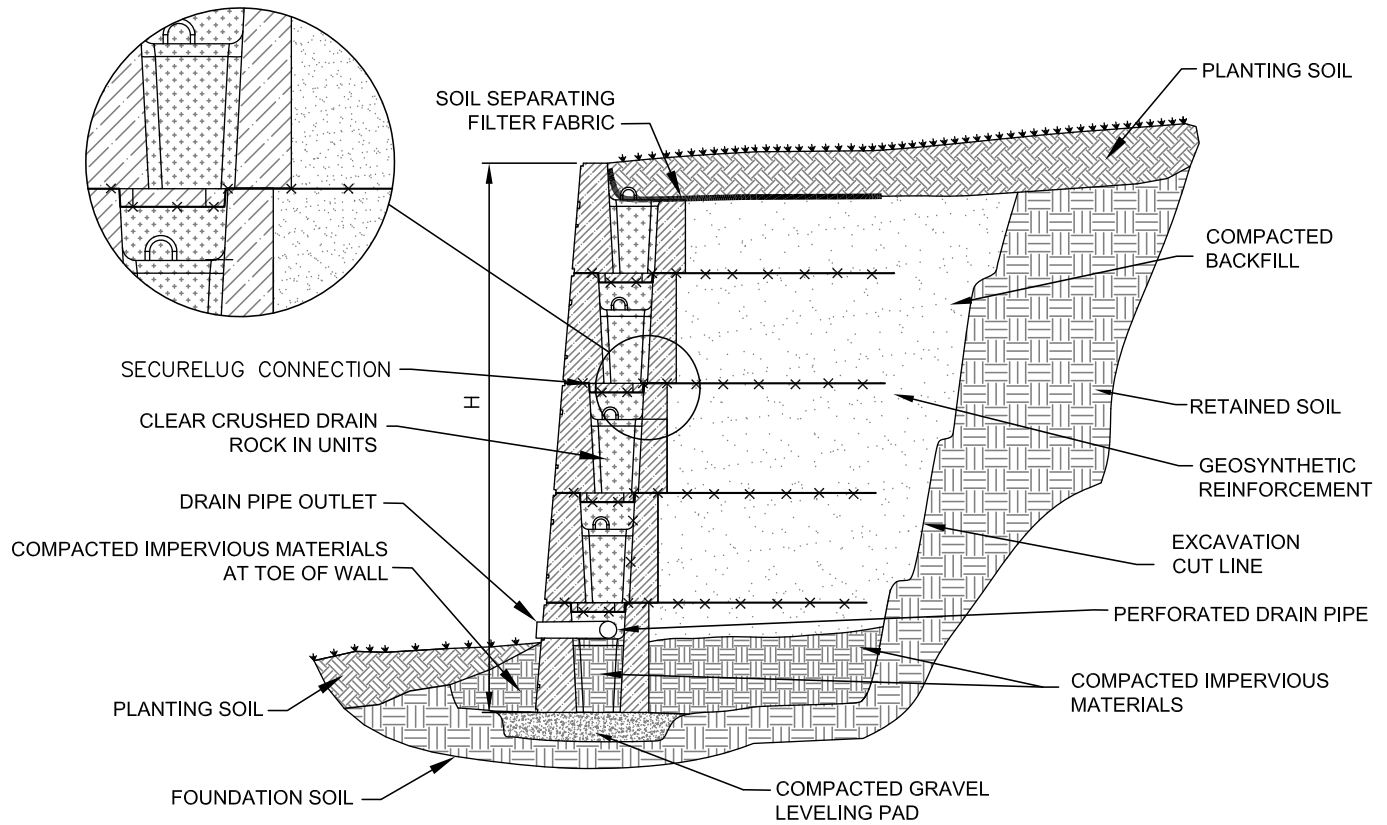

> > > MagnumStone™ Positive Connection Wall

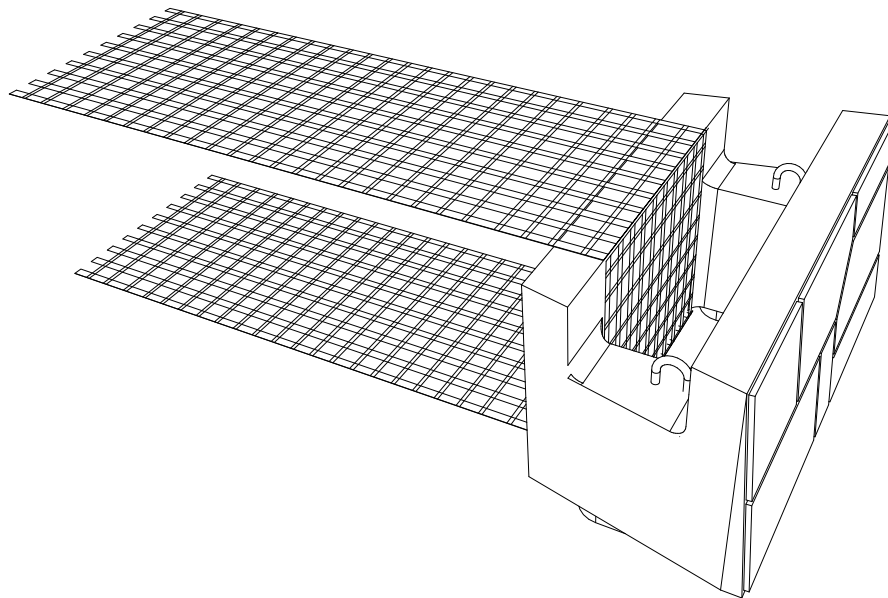
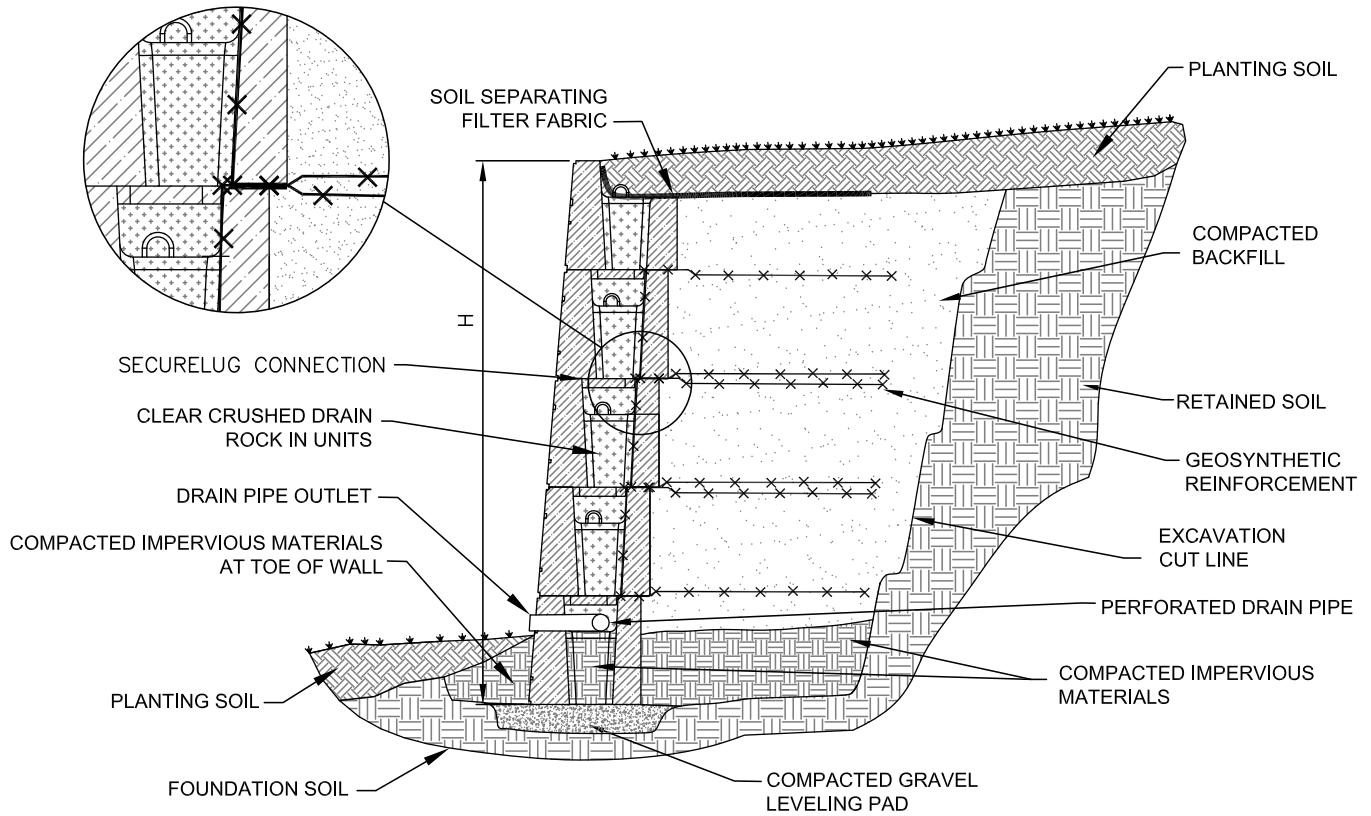

> > > MagnumStone™ Steel/Concrete Wall

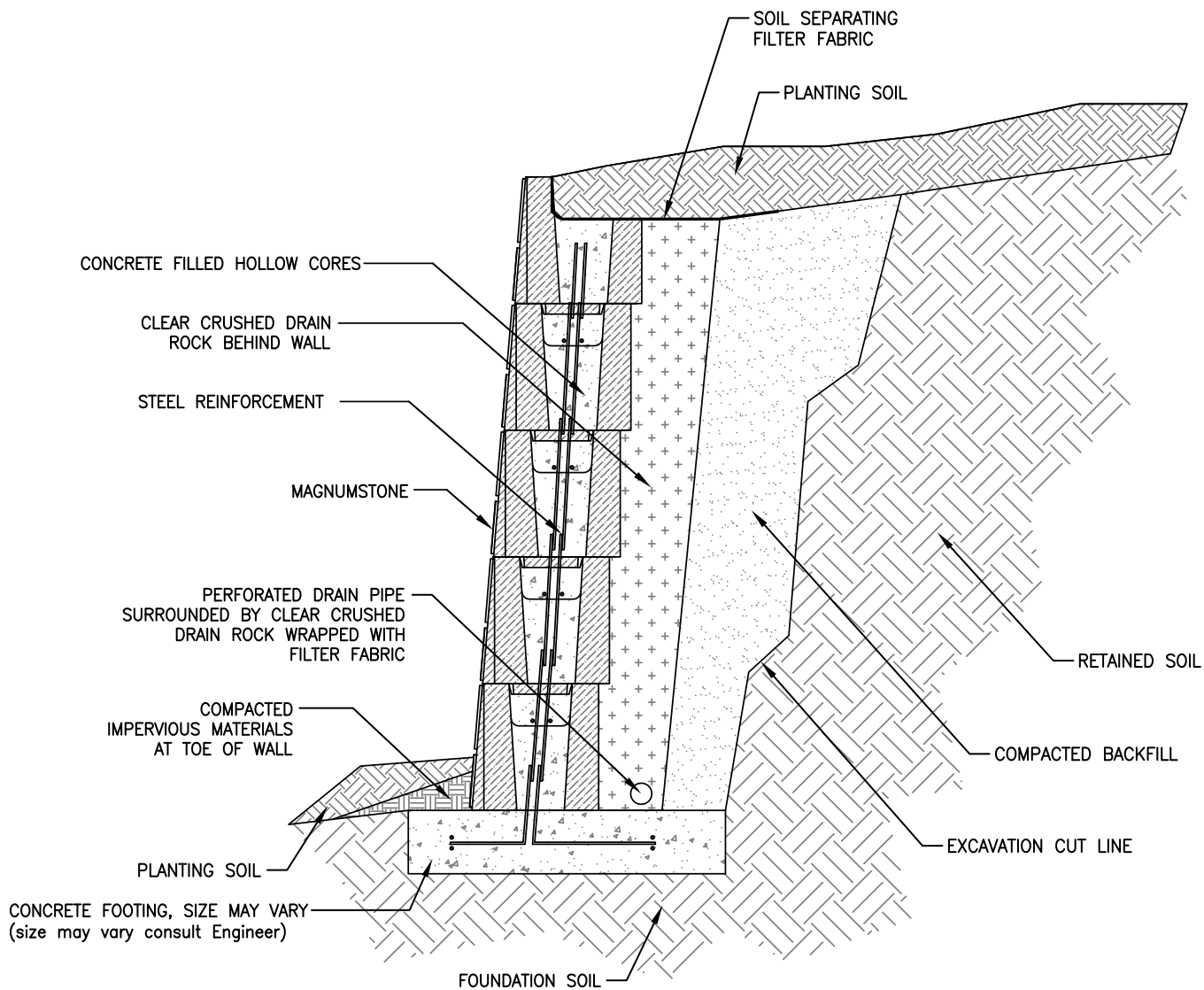

> > > MagnumStone™ Free Standing Double Sided Wall

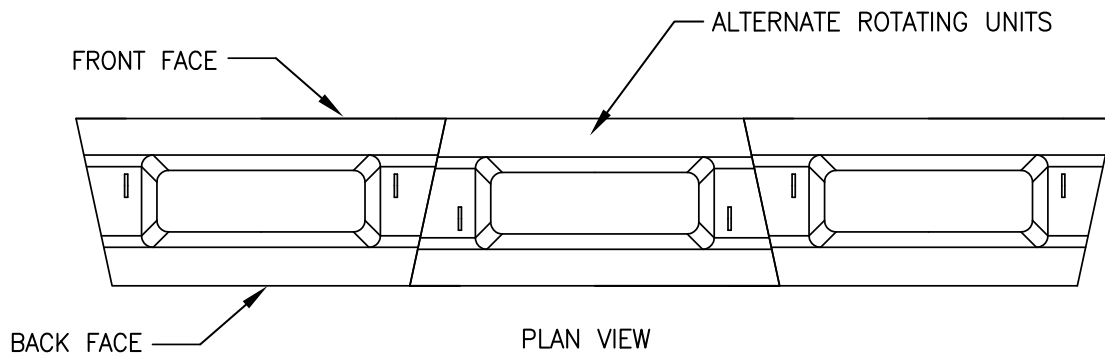
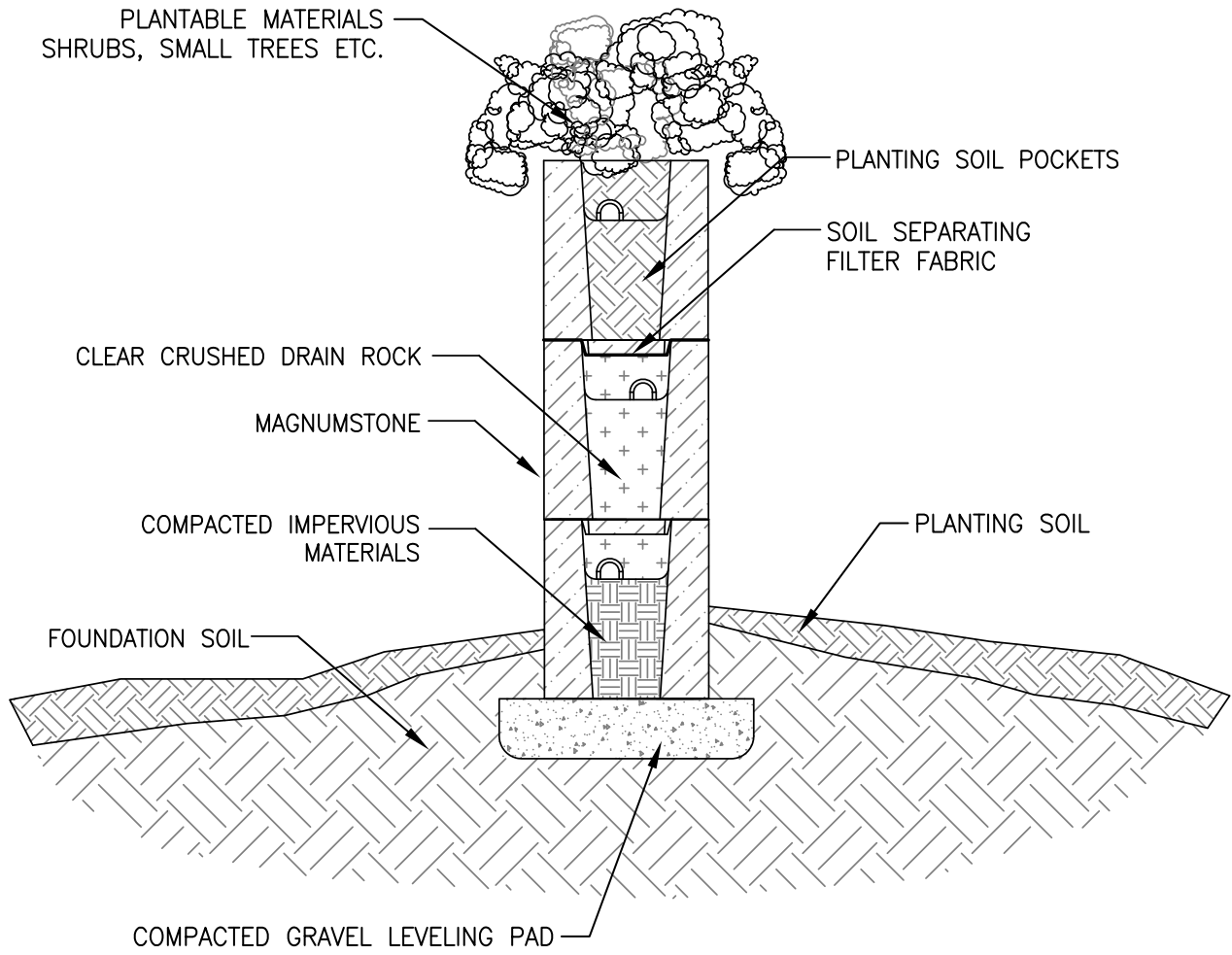

DISCLAIMER: This product is not available in all areas.

MagnumStone™ Technical Reference | © Magnum Forms Inc. | magnumforms.ca

>>>INTERLOCK

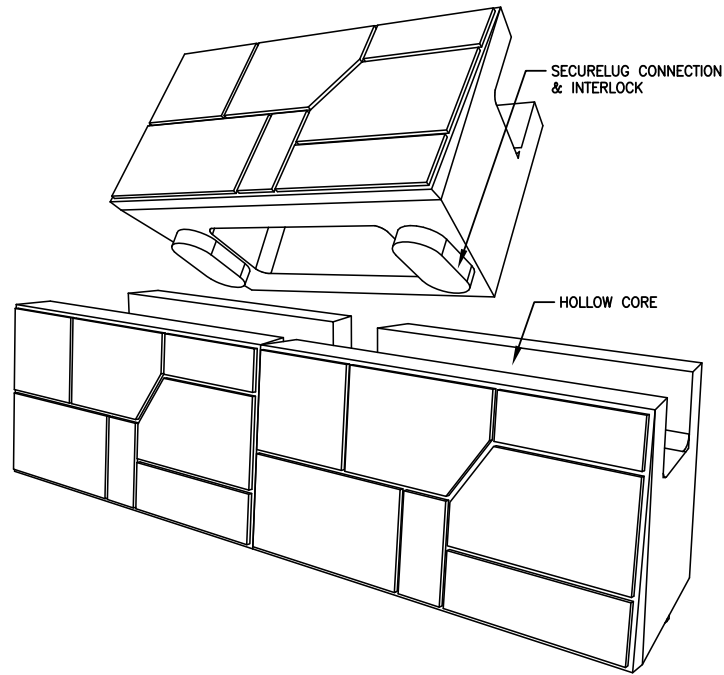

>>>VERTICAL PERMEABILITY

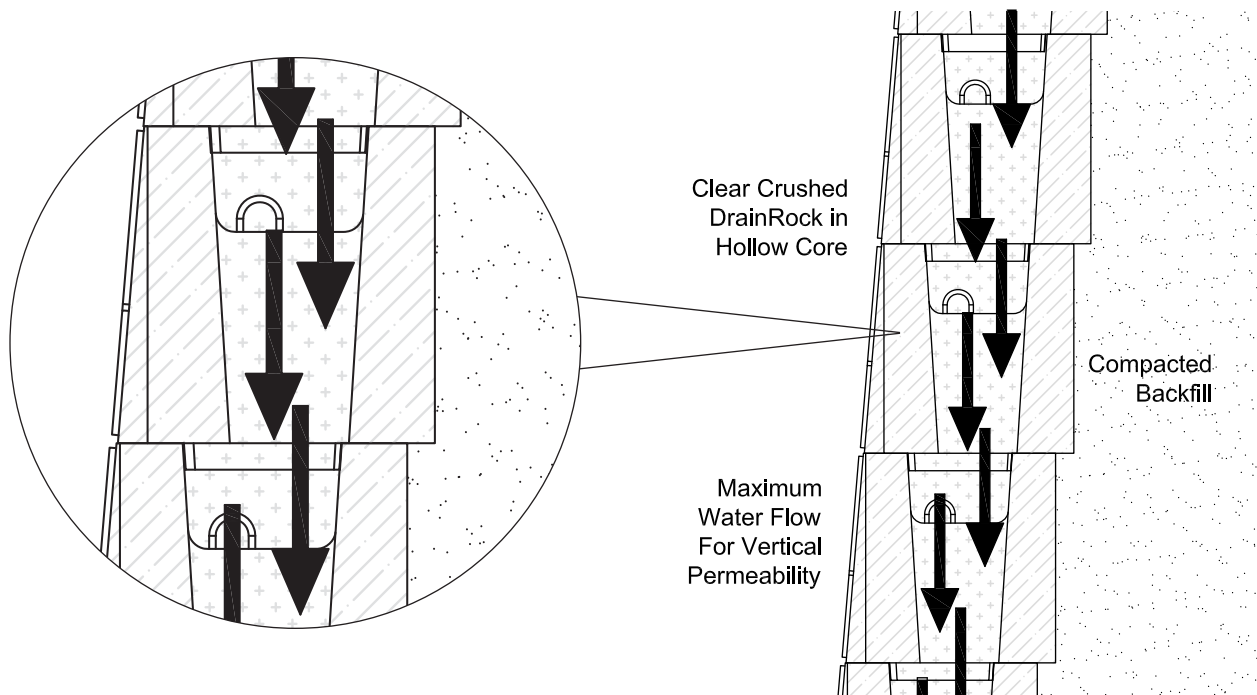

> > > MagnumStone™ Top of Wall Detail

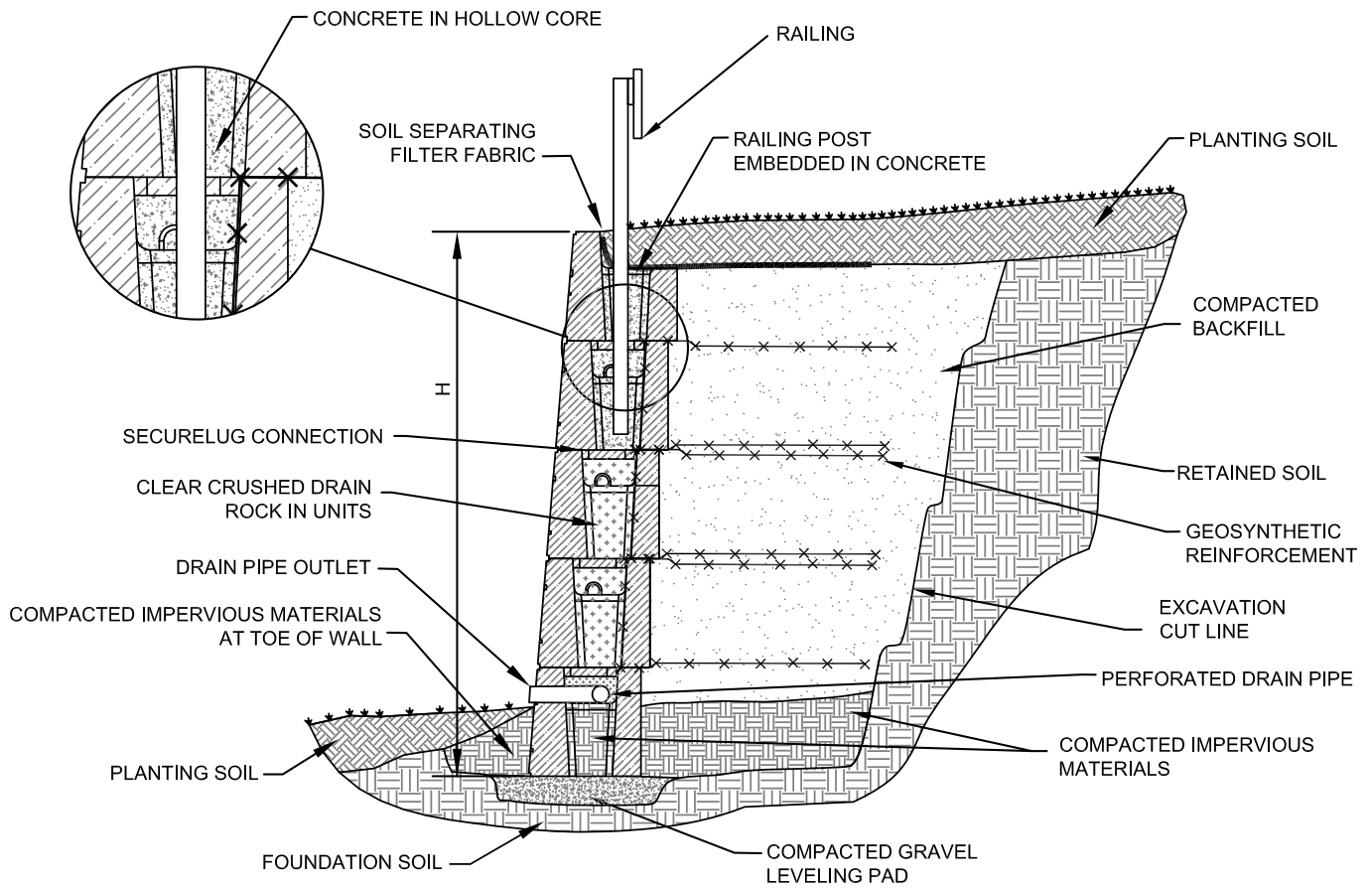

MAGNUMSTONE™ MARKETING MATERIALS

If you require more information on MagnumStone™ please visit our website at magnumforms.ca.



Magnum Forms Inc Website



General Brochure



Installation Guide



Technical Reference



www.magnumforms.ca EMAIL info@magnumforms.ca